

Data-Driven Occupancy Load Workflow Using Revit

EvolveLAB Code Tools

Clara Fonte Boa
Design Technologist | EvolveLAB

Jim Greve
BIM Manager | EvolveLAB



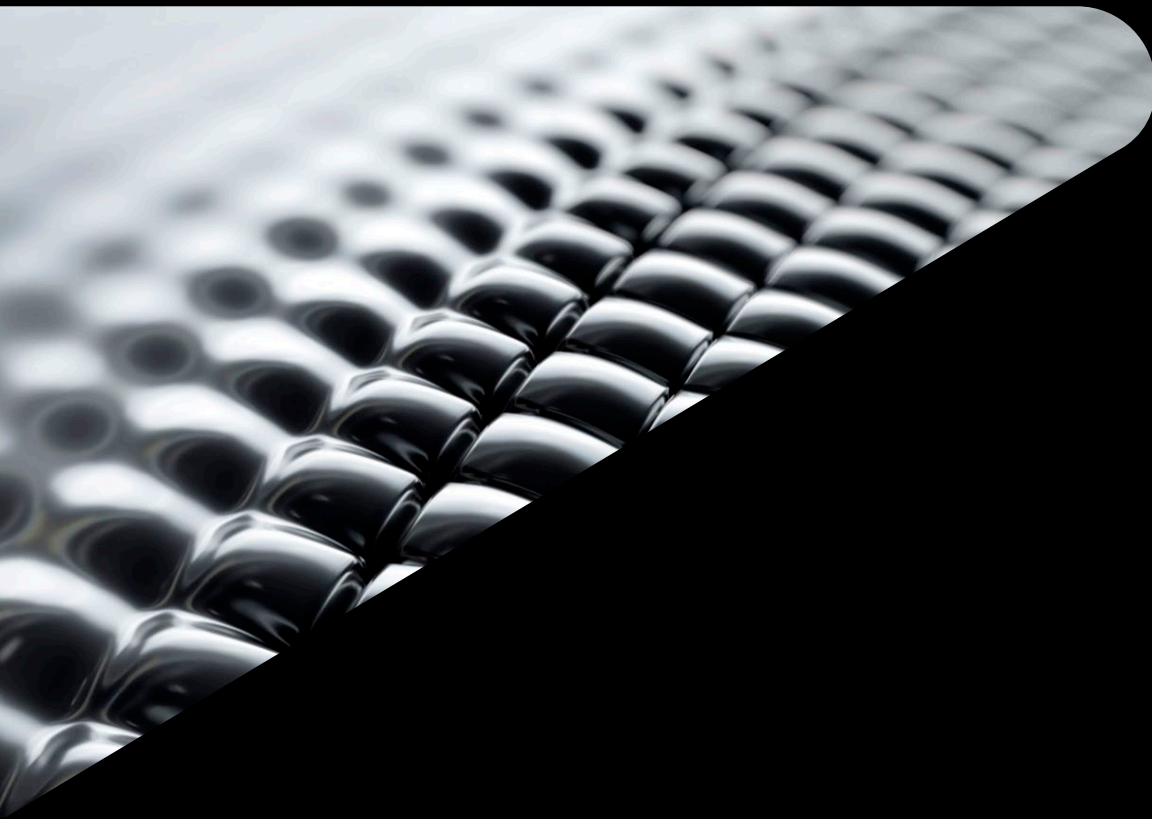

Who are we?



EvolveLAB

- Automation & Interoperability Products
 - Helix, Glyph, EvolveGD, etc.
- Custom App Development
- BIM Support & Training
- Computational Design

**“Helping Architects,
Engineers, and
Construction
Professionals implement
Design Technology”**

Clara Fonte Boa

Design Technologist | EvolveLAB

- Universidade Federal de Ouro Preto, Brazil
 - 5-year Bach in Architecture, Urban Planning and Landscape Architecture.
 - 1-year at Dessau Institute of Architecture, Germany.
- 7 years Architecture
- 3 years as Design Technologist
 - BIM Management
 - Dynamo and light coding
 - UI/UX Design
- Lego Builds & Pottery



Jim Greve

BIM Manager | EvolveLAB

- 20 Years Design/Production Experience in the AEC Industry
 - CAD Tech to BIM Manager
 - Architectural Design
 - Multi-Discipline Design
 - Terrestrial LiDAR Specialist
 - Autodesk Recap
- BIM Management
 - Training
 - Client Relations
 - BIM Consulting
- Music Gear



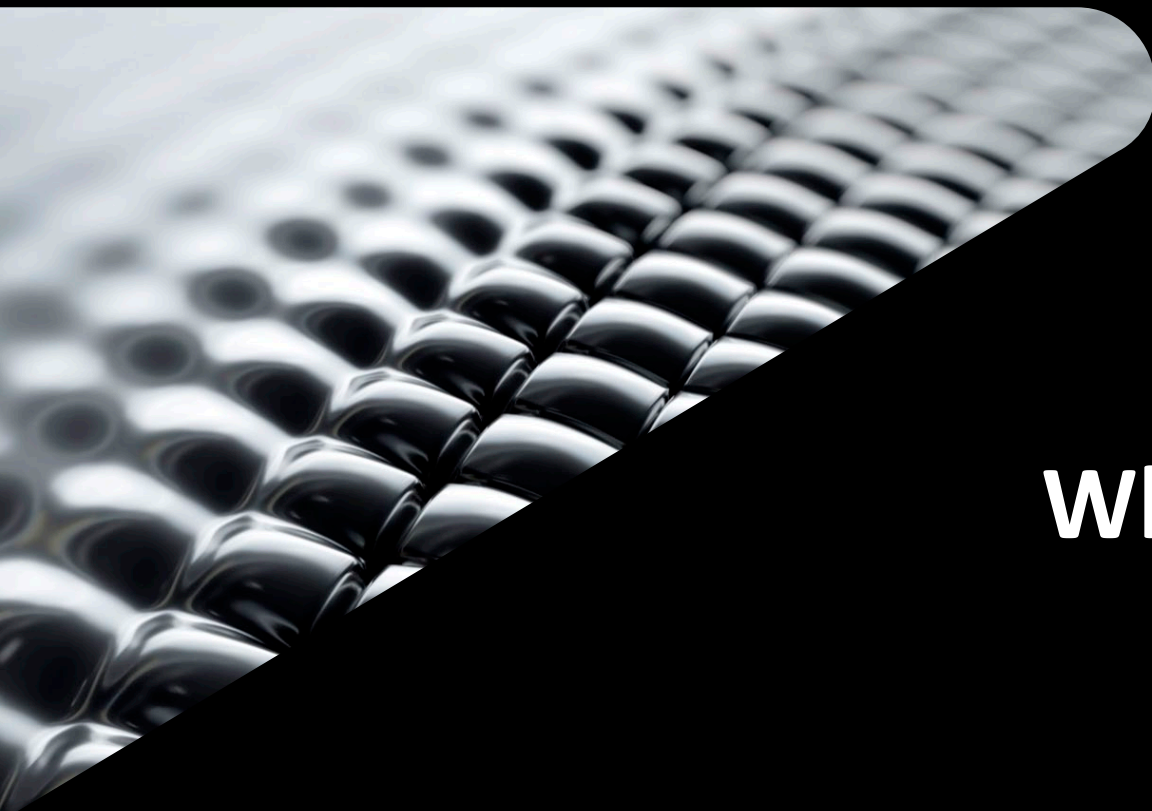

Why are we here?

What are the Code Tools?

- Automated Code Analysis
- Occupancy Classification:
 - IBC, chapter 3
- Number of Occupants Calculation:
 - IBC, chapter 10
- Out of the Box Tools

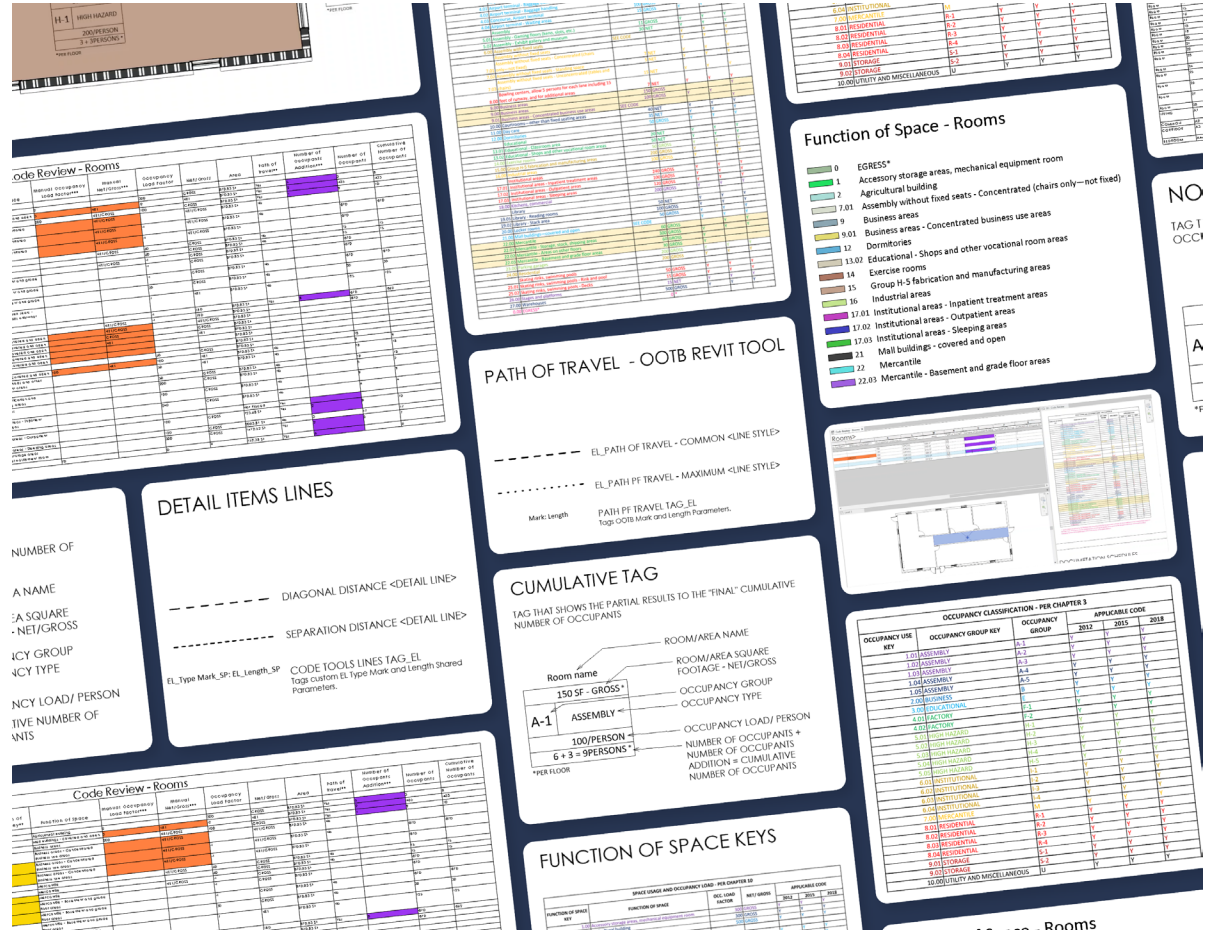

Rooms

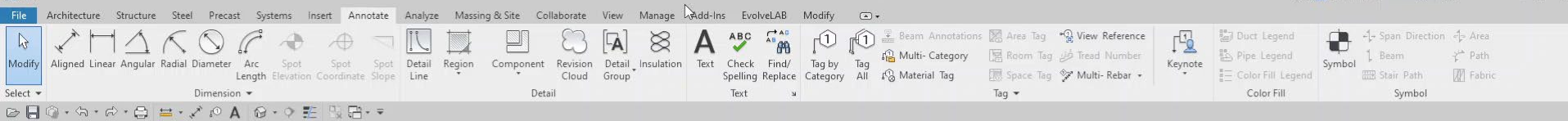

Properties

00 - Code Review

Sheet

Sheet: Code Review Edit Type

Graphics

Visibility/Graphics ... Edit...

Scale As indicated

Identity Data

Dependency Independent

Referencing Sheet

Referencing Detail

Current Revision Iss... ☐

Current Revision Iss... ☐

Current Revision Iss... ☐

Current Revision Date

Current Revision De...

Current Revision

Approved By Approver

Designed By Designer

Checked By Checker

Drawn By Author

Sheet Number 00

Sheet Name Code Review

Sheet Issue Date 10/03/18

EL_Filter_SP

Appears In Sheet List ☒

Revisions on Sheet Edit...

Other

File Path C:\Users\JimGreve\E...

Guide Grid <None>

Properties help Apply

REBAR FILE CODE TOOLS

DISCLAIMER

SECTION AND AREA TOOL

NON-CALCULATIVE TOOL

ANALYTICAL TOOL

GUIDE TOOL

DETAIL TOOL

CODE TOOLS CUSTOM PARAMETERS

FUNCTION OF BRANCHES

DOCUMENTATION SCHEDULE

CodeTools - Detail

CodeTools - Section

CodeTools - Schedule

Function of Branches

Section Legend

Section Legend

Color Fill Legend

Symbol

Span Direction

Beam

Stair Path

Area

Path

Fabric

How do the Code Tools use Revit?

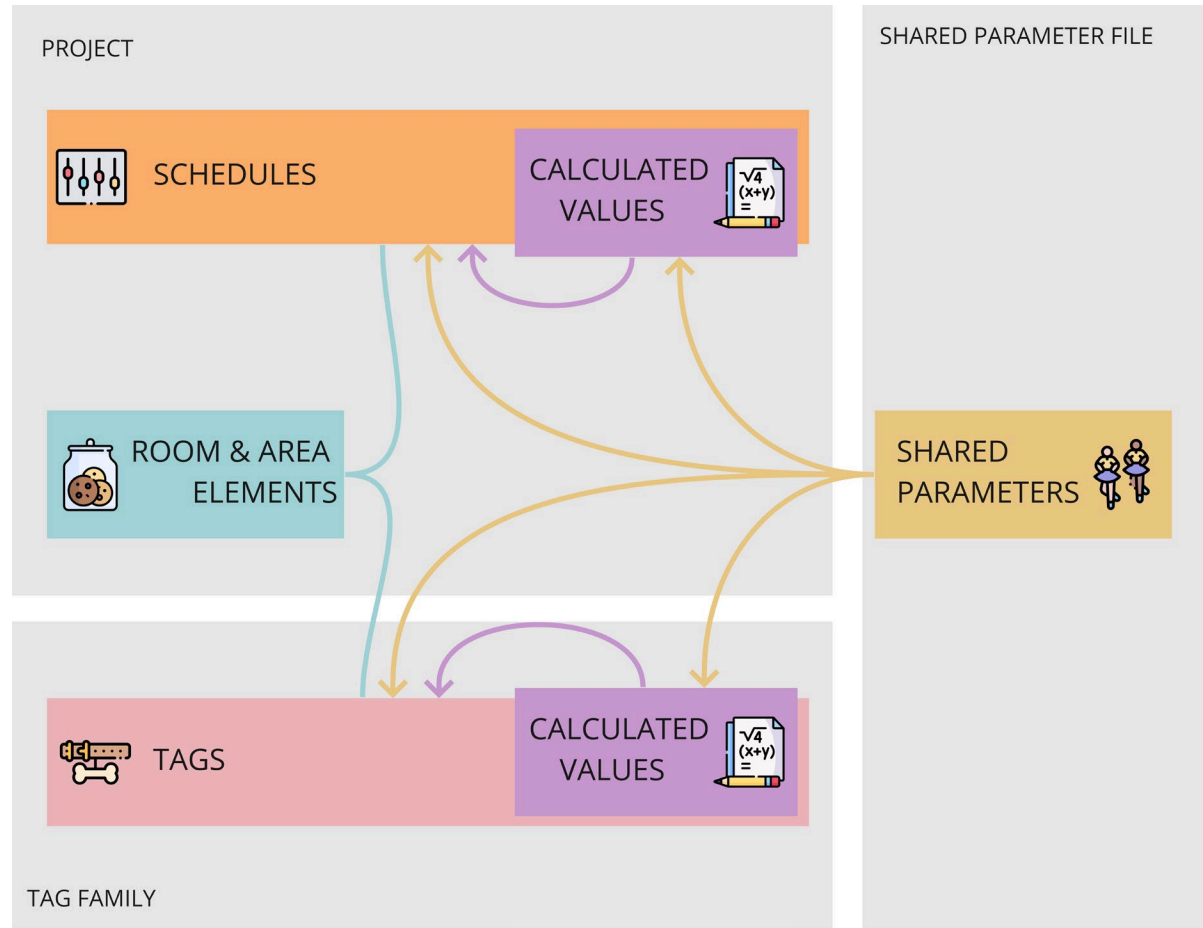

A close-up, black and white photograph of a highly reflective, woven mesh or fabric texture. The mesh is composed of many small, rounded, interconnected elements that create a complex, three-dimensional pattern. The lighting highlights the glossy surface, creating bright reflections and deep shadows that emphasize the texture. The image is partially obscured by a black diagonal shape that serves as a background for the text.

**How do
the Code Tools use
these Revit features?**

Room & Area Elements

- What are Rooms and Area Elements?
 - The cookie jar
- When to use each?
 - Rooms
 - Quicker
 - Uses walls & other elements
 - Areas
 - Versatile
 - Many types in same space

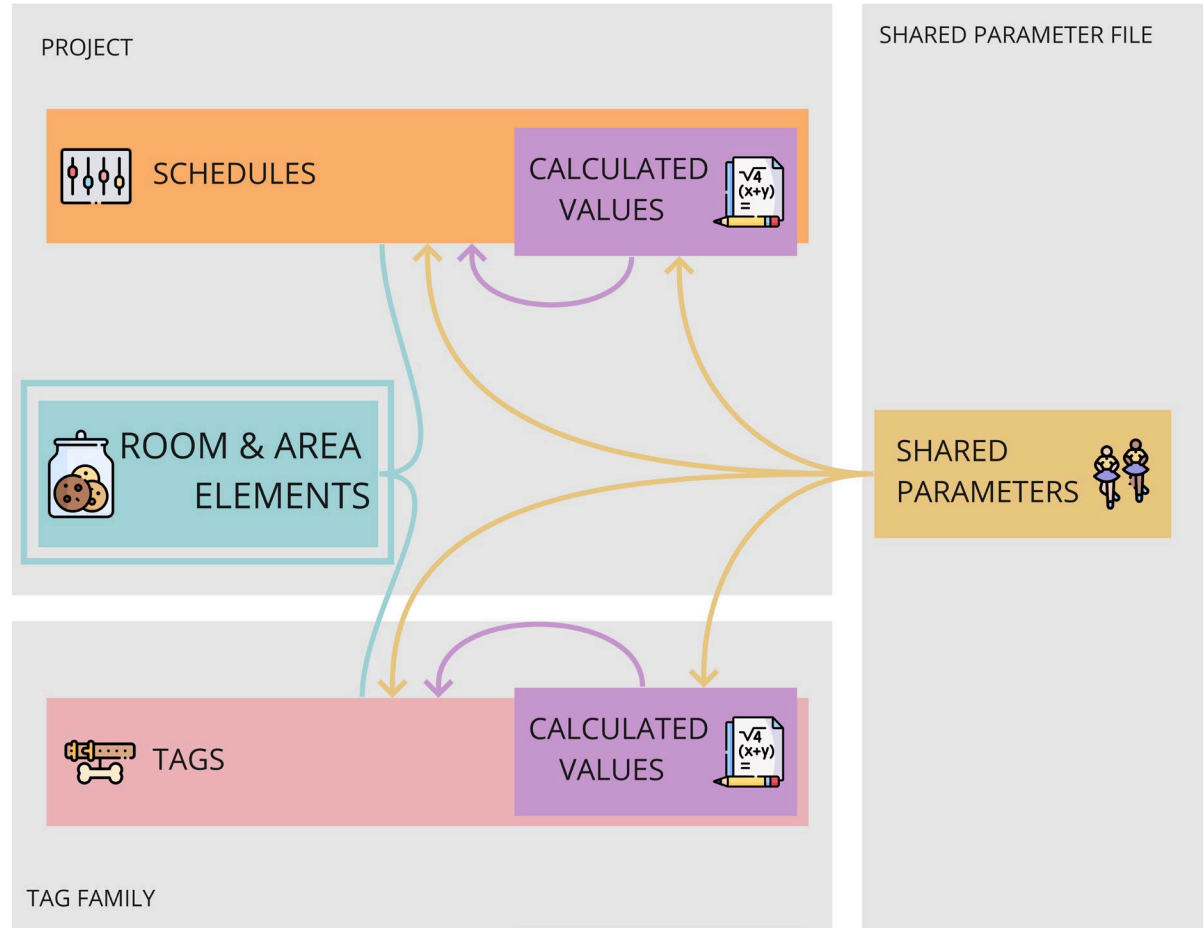

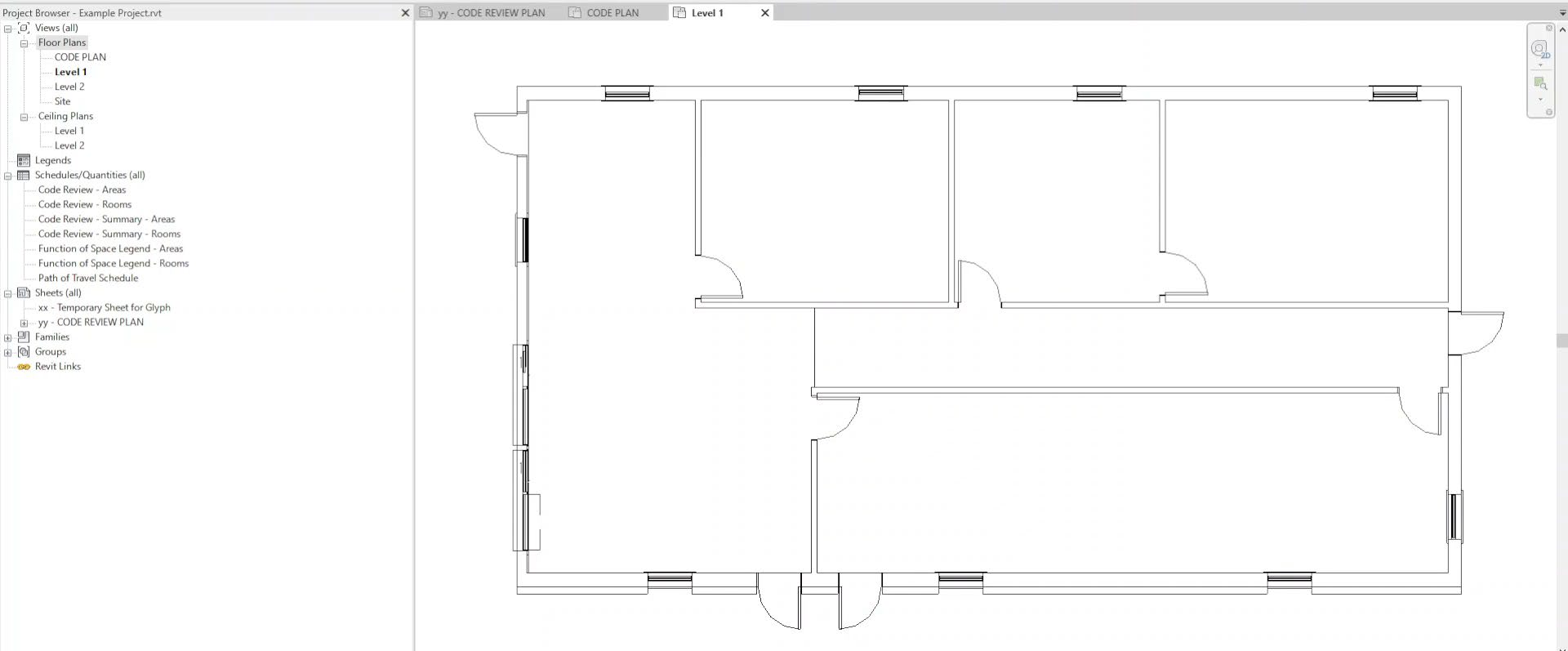
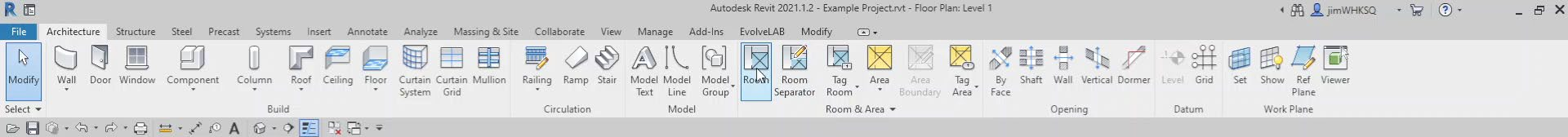

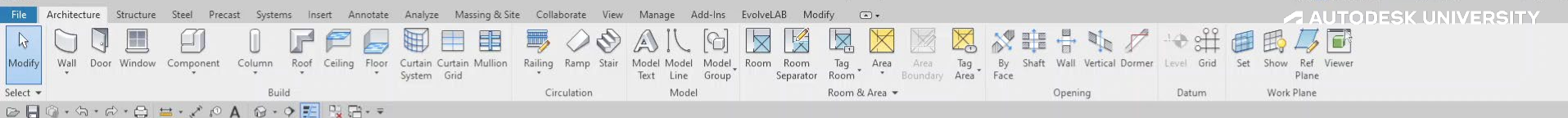

Properties

yy - CODE REVIEW PLAN CODE PLAN Level 1 (3D)

Floor Plan

Floor Plan: Level 1 Edit Type

Graphics

View Scale	1/8" = 1'-0"
Scale Value 1:	96
Display Model	Normal
Detail Level	Coarse
Parts Visibility	Show Original
Visibility/Graphics Overrides	Edit...
Graphic Display Options	Edit...
Orientation	Project North
Wall Join Display	Clean all wall joins
Discipline	Coordination
Show Hidden Lines	By Discipline
Color Scheme Location	Background
Color Scheme	<none>
System Color Schemes	Edit...
Default Analysis Display Style	None
Sun Path	<input type="checkbox"/>

Underlay

Range: Base Level	None
Range: Top Level	Unbounded
Underlay Orientation	Look down

Extents

Crop View	<input type="checkbox"/>
Crop Region Visible	<input type="checkbox"/>
Annotation Crop	<input type="checkbox"/>
View Range	Edit...
Associated Level	Level 1
Scope Box	None
Column Symbolic Offset	1' 0"
Depth Clipping	No clip

Identity Data

View Template	<None>
View Name	Level 1
Dependency	Independent
Title on Sheet	
Referencing Sheet	

[Properties help](#) Apply

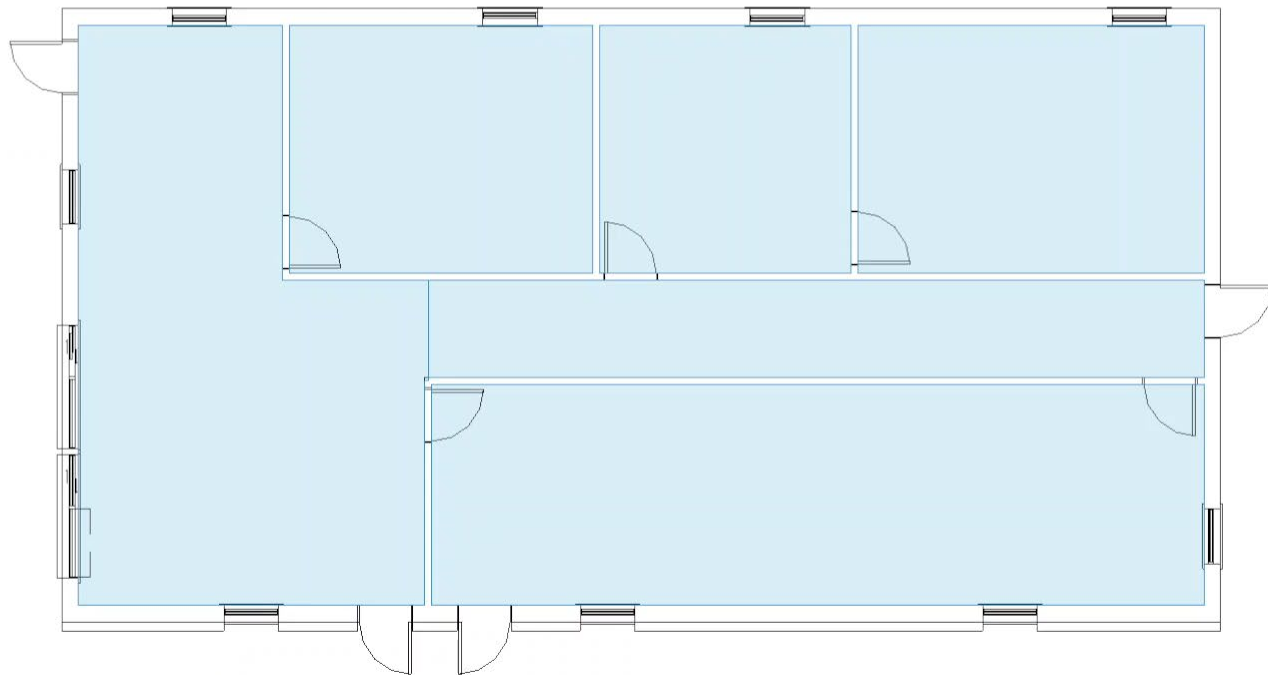

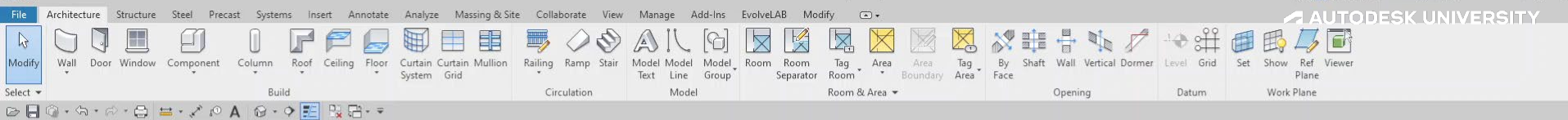

Properties

Level 1 CODE PLAN

Floor Plan

Floor Plan: Level 1 Edit Type

Graphics

View Scale	1/4" = 1'-0"
Scale Value 1:	48
Display Model	Normal
Detail Level	Coarse
Parts Visibility	Show Original
Visibility/Graphics Overrides	Edit...
Graphic Display Options	Edit...
Orientation	Project North
Wall Join Display	Clean all wall joins
Discipline	Coordination
Show Hidden Lines	By Discipline
Color Scheme Location	Background
Color Scheme	<none>
System Color Schemes	Edit...
Default Analysis Display Style	None
Sun Path	<input type="checkbox"/>

Underlay

Range: Base Level	None
Range: Top Level	Unbounded
Underlay Orientation	Look down

Extents

Crop View	<input type="checkbox"/>
Crop Region Visible	<input type="checkbox"/>
Annotation Crop	<input type="checkbox"/>
View Range	Edit...
Associated Level	Level 1
Scope Box	None
Column Symbolic Offset	1' 0"
Depth Clipping	No clip

Identity Data

View Template	<None>
View Name	Level 1
Dependency	Independent
Title on Sheet	
Referencing Sheet	

Apply

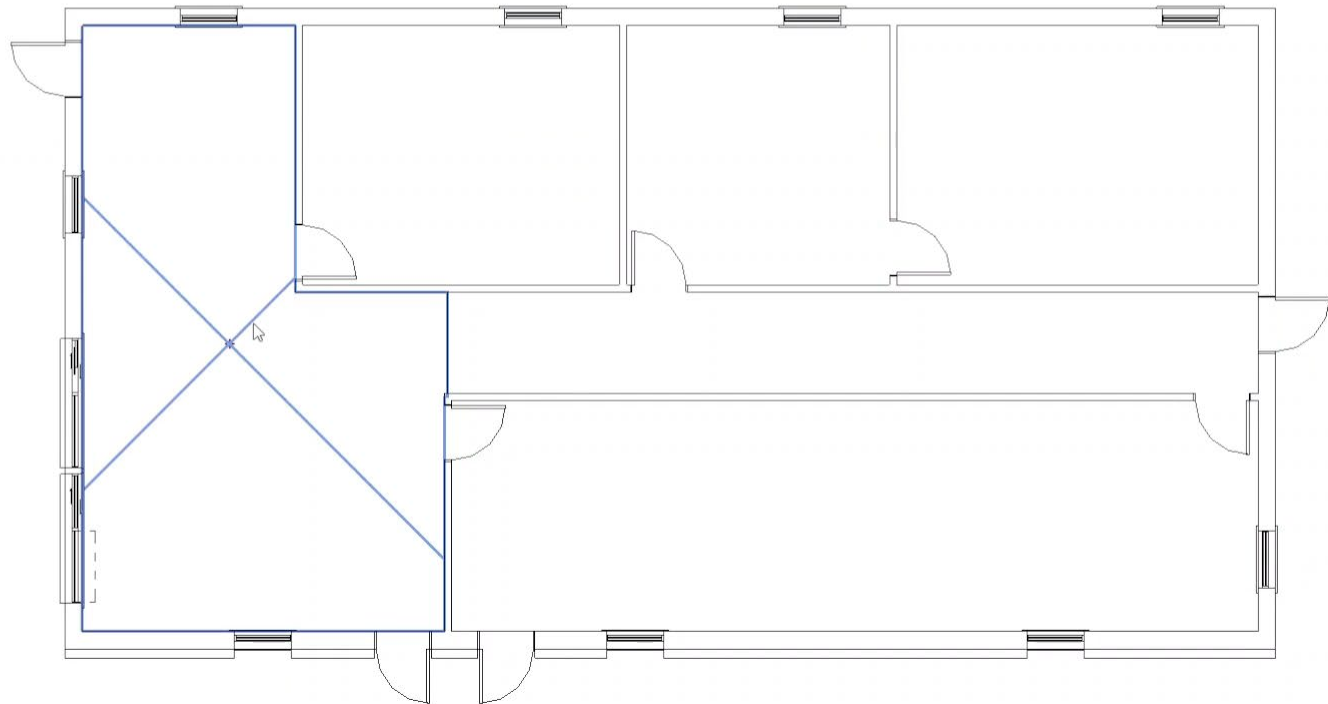

Schedules

- What are schedules?
 - The user interface
- How do the Code Tools use schedules?
 - QA/QC schedules
 - Partial results
 - Conditional Formatting
 - Color Coding
 - Documentation schedules
 - Only relevant results
 - Ready for Code Plans

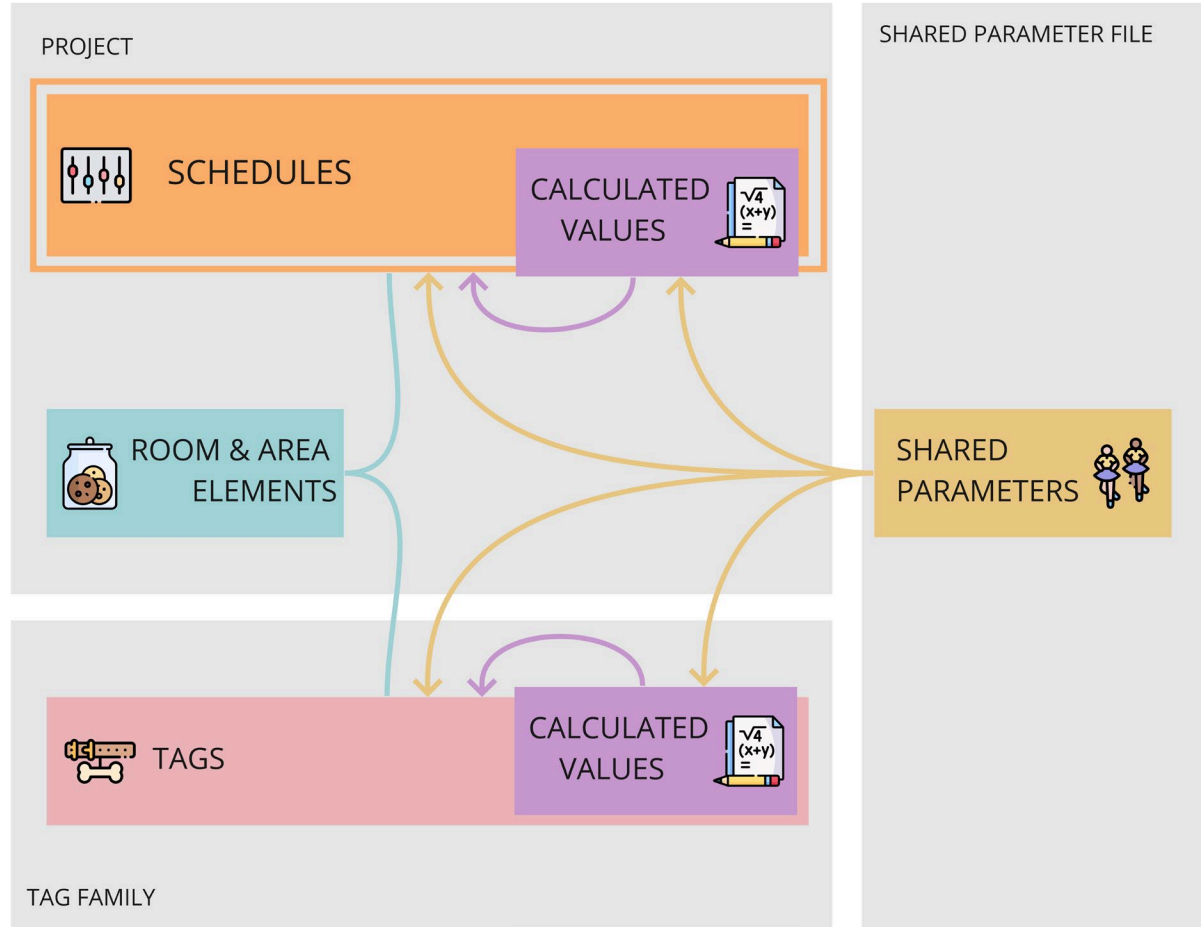

<Code Review - Rooms>

A	B	C	D	E	F	G	H	I	J	K	L	M	N	O	P	Q
Name	Number	Code Year**	Occupancy Use Key**	Occupancy Group Key	Occupancy Group	Function Of space Key**	Function Of space	Manual Occupancy Load Factor**	Manual Net/Gross***	Occupancy Load Factor	Net/Gross	Area	Path of travel**	Number Of Occupants Additio	Number Of Occupant	Cumulative Number Of
Room	1	2018		TBD	TBD	2	Agricultural building			300	GROSS	870.83 SF		5	3	8
Room	2	2020	1.01	A-1	ASSEMBLY	21	Mall buildings - covered and open	3	NET	-2	NET	870.83 SF		2	-435	-433
Room	3	2012	1.03	A-3	ASSEMBLY	9	Business areas	200	NET/GROSS	100	GROSS	870.83 SF		3	9	10
Room	4	2018	1.04	A-4	ASSEMBLY	9.01	Business areas - Concentrated business use		NET/GROSS		NET/GROSS	870.83 SF				
Room	5	2015	1.05	A-5	ASSEMBLY	9.03	Business areas - Concentrated business use		NET/GROSS	-1	NET/GROSS	870.83 SF				-870
Room	6	2012	2	B	BUSINESS	9.01	Business areas - Concentrated business use		NET/GROSS	-1	NET/GROSS	870.83 SF				-870
Room	7	2018	3	E	EDUCATIONAL	22	Mercantile		NET/GROSS	60	GROSS	870.83 SF			15	15
Room	8	2015	4.01	F-1	FACTORY	22	Mercantile			60	GROSS	870.83 SF			15	15
Room	9	2012	4.02	F-2	FACTORY	22	Mercantile		NET/GROSS	-1	GROSS	870.83 SF				-870
Room	10	2018	5.01	H-1	HIGH HAZARD	22.03	Mercantile - basement and grade floor are			-1	GROSS	870.83 SF				-870
Room	11	2018	5.02	H-2	HIGH HAZARD	22.03	Mercantile - basement and grade floor are			-1	GROSS	870.83 SF				-870
Room	12	2012	5.03	H-3	HIGH HAZARD	22.03	Mercantile - basement and grade floor are			30	GROSS	870.83 SF			30	30
Room	13	2018	5.04	H-4	HIGH HAZARD	7.01	Assembly without fixed seats - concentra			7	NET	870.83 SF			125	125
Room	14	2018	5.05	H-5	HIGH HAZARD	100	TBD			-1	TBD	870.83 SF		5	-870	-862
Room	15	2018	6.01	I-1	INSTITUTIONAL	3333	TBD		NET/GROSS	-1	TBD	870.83 SF				-870
Room	16	2012	6.02	I-2	INSTITUTIONAL	21	Mall buildings - covered and open		NET/GROSS		NET/GROSS	870.83 SF				
Room	17	2018	6.03	I-3	INSTITUTIONAL	21	Mall buildings - covered and open		GROSS		GROSS	870.83 SF				
Room	18	2015	6.04	I-4	INSTITUTIONAL	21	Mall buildings - covered and open		NET		NET	870.83 SF				
Room	19	2012	7	M	MERCANTILE	21	Mall buildings - covered and open					870.83 SF				
Room	20	2018	7	M	MERCANTILE	21	Mall buildings - covered and open					870.83 SF				
Room	21	2018	8.02	R-2	RESIDENTIAL	12	Dormitories			50	GROSS	870.83 SF			18	
Room	22	2018	8.03	R-3	RESIDENTIAL	21	Mall buildings - covered and open	100	NET	100	NET	870.83 SF			9	9
Room	23	2018	8.04	R-4	RESIDENTIAL	13.02	Educational - shops and other vocational r			50	NET	870.83 SF			18	18
Room	24	2018	9.01	S-1	STORAGE	14	Exercise rooms			50	GROSS	870.83 SF			18	18
Room	25	2018	9.02	S-2	STORAGE	16	Group H-5 fabrication and manufacturing a			20	GROSS	870.83 SF			5	5
Room	26	2018	10	U	UTILITY AND MISCELLANEO	16	Industrial areas			100	GROSS	870.83 SF			9	9
Room	27	2018	11	TBD	TBD	17.01	Institutional areas - Inpatient treatment or			240	GROSS	870.83 SF			4	4
Room	28	2019	2	B	BUSINESS						Not Placed					
LIVING	A1	2018	4.01	F-1	FACTORY	17.02	Institutional areas - Outpatient areas			100	GROSS	723.68 SF		2	8	10
COMMON	A2	2019	1.03	A-3	ASSEMBLY	17.03	Institutional areas - Sleeping areas			120	GROSS	2005.91 SF		3	17	17
CORRIDOR	A3	2019	2	B	BUSINESS	1	Accessory storage areas, mechanical equi			30	GROSS	1,412.53 SF		3	5	7
SLEEPING	A4	2019	1.02	A-2	ASSEMBLY	0	BOARDS*	70		0	*	152.38 SF		5	5	6

OCCUPANCY CLASSIFICATION - PER CHAPTER 3						
OCCUPANCY USE KEY	OCCUPANCY GROUP KEY	OCCUPANCY GROUP	APPLICABLE CODE			
			2012	2015	2018	
1.01	ASSEMBLY	A-1	Y	Y	Y	
1.02	ASSEMBLY	A-2	Y	Y	Y	
1.03	ASSEMBLY	A-3	Y	Y	Y	
1.04	ASSEMBLY	A-4	Y	Y	Y	
1.05	ASSEMBLY	A-5	Y	Y	Y	
2.00	BUSINESS	B	Y	Y	Y	
3.00	EDUCATIONAL	E	Y	Y	Y	
4.01	FACTORY	F-1	Y	Y	Y	
4.02	FACTORY	F-2	Y	Y	Y	
5.01	HIGH HAZARD	H-1	Y	Y	Y	
5.02	HIGH HAZARD	H-2	Y	Y	Y	
5.03	HIGH HAZARD	H-3	Y	Y	Y	
5.04	HIGH HAZARD	H-4	Y	Y	Y	
5.05	HIGH HAZARD	H-5	Y	Y	Y	
6.01	INSTITUTIONAL	I-1	Y	Y	Y	
6.02	INSTITUTIONAL	I-2	Y	Y	Y	
6.03	INSTITUTIONAL	I-3	Y	Y	Y	
6.04	INSTITUTIONAL	I-4	Y	Y	Y	
7.00	MERCANTILE	M	Y	Y	Y	
8.01	RESIDENTIAL	R-1	Y	Y	Y	
8.02	RESIDENTIAL	R-2	Y	Y	Y	
8.03	RESIDENTIAL	R-3	Y	Y	Y	
8.04	RESIDENTIAL	R-4	Y	Y	Y	
9.01	STORAGE	S-1	Y	Y	Y	
9.02	STORAGE	S-2	Y	Y	Y	
10.00	UTILITY AND MISCELLANEOUS	U	Y	Y	Y	

SPACE USAGE AND OCCUPANCY LOAD - PER CHAPTER 10							
FUNCTION OF SPACE KEY	FUNCTION OF SPACE	OCC. LOAD FACTOR	NET/ GROSS	APPLICABLE CODE			
				2012	2015	2018	
1.00	Accessory storage areas, mechanical equipment room	300	GROSS	Y	Y	Y	
2.00	Agricultural building	300	GROSS	Y	Y	Y	
3.00	Aircraft hangars	500	GROSS	Y	Y	Y	
	Airport terminal						
4.01	Airport terminal - Baggage claim	20	GROSS	Y	Y	Y	
4.02	Airport terminal - Baggage handling	300	GROSS	Y	Y	Y	
4.03	Concourse, Airport terminal	100	GROSS	Y	Y	Y	
4.04	Airport terminal - Waiting areas	15	GROSS	Y	Y	Y	
	Assembly						
5.01	Assembly - Gaming floors (keno, slots, etc.)	11	GROSS	Y	Y	Y	
5.02	Assembly - Exhibit gallery and museum	30	NET	Y	Y	Y	
6.00	Assembly with fixed seats	SEE CODE		Y	Y	Y	
	Assembly without fixed seats			Y	Y	Y	
7.01	Assembly without fixed seats - Concentrated (chairs only - not fixed)	7	NET	Y	Y	Y	
7.02	Assembly without fixed seats - Standing space	9	NET	Y	Y	Y	
7.03	Assembly without fixed seats - Unconcentrated (tables and chairs)	15	NET	Y	Y	Y	
8.00	Bowling centers, allow 5 persons for each lane including 15 feet of runway, and for additional areas	7	NET	Y	Y	Y	
9.00	Business areas	150	GROSS			Y	
9.00	Business areas	100	GROSS	Y	Y		
9.01	Business areas - Concentrated business use areas	SEE CODE				Y	
10.00	Courtrooms—other than fixed seating areas	40	NET	Y	Y	Y	
11.00	Day care	35	NET	Y	Y	Y	
12.00	Dormitories	50	GROSS	Y	Y	Y	
	Educational						
13.01	Educational - Classroom area	20	NET	Y	Y	Y	
13.02	Educational - Shops and other vocational room areas	50	NET	Y	Y	Y	
14.00	Exercise rooms	50	GROSS	Y	Y	Y	
15.00	Group H-S fabrication and manufacturing areas	200	GROSS	Y	Y	Y	
16.00	Industrial areas	100	GROSS	Y	Y	Y	
	Institutional areas						
17.01	Institutional areas - Inpatient treatment areas	240	GROSS	Y	Y	Y	
17.02	Institutional areas - Outpatient areas	100	GROSS	Y	Y	Y	
17.03	Institutional areas - Sleeping areas	120	GROSS	Y	Y	Y	
18.00	Kitchens, commercial	200	GROSS	Y	Y	Y	
	Library						
19.01	Library - Reading rooms	50	NET	Y	Y	Y	
19.02	Library - Stack area	100	GROSS	Y	Y	Y	
20.00	Locker rooms	50	GROSS	Y	Y	Y	
21.00	Mall buildings—covered and open	SEE CODE		Y	Y	Y	
22.00	Mercantile	60	GROSS		Y	Y	
22.01	Mercantile - Storage, stock, shipping areas	300	GROSS	Y	Y	Y	
22.02	Mercantile - Areas on other floors	60	GROSS	Y			
22.03	Mercantile - Basement and grade floor areas	30	GROSS	Y			
23.00	Parking garages	200	GROSS	Y	Y	Y	
24.00	Residential	200	GROSS	Y	Y	Y	
	Skating rinks, swimming pools						
25.01	Skating rinks, swimming pools - Rink and pool	50	GROSS	Y	Y	Y	
25.02	Skating rinks, swimming pools - Decks	15	GROSS	Y	Y	Y	
26.00	Stages and platforms	15	NET	Y	Y	Y	
27.00	Warehouses	500	GROSS	Y	Y	Y	
0.00	EGRESS*	0*					

Autodesk Revit 2021.1.2 - Project1 - Schedule: Code Review - Rooms

File Architecture Structure Steel Precast Systems Insert Annotate Analyze Massing & Site Collaborate View Manage Add-Ins EvolveLAB Modify Modify Schedule/Quantities

Properties Parameters Columns Rows Titles & Headers Appearance Element Not Placed/Unenclosed Error

Modify Schedule/Quantities

Code Review - Rooms

<Code Review

A	B	C	D	E	F	G	H	I
Name	Number	Code Year*	Occupancy Use Key	Occupancy Group Key	Occupancy Group	Function Of Space Key*	Function Of Space	Manual Occupancy
LOBBY	101							
OFFICE 1	102							
OFFICE 2	103							
STORAGE	104							
CORRIDOR	105							
WORKSHOP	106							

Level 1

Properties help Apply

00 - Code Review

KEY TO BUILD SPACE (UNIT OF AREA): TO HELP GROUP TOGETHER, IT SET FILLING KEY TO VERTICAL, LINE ALIGNING A LEFT WITH THE PARTITION DATA WITH
Occupancy Group and Occupancy Group Key will be assigned as "TBD". A value for this parameter must always be inputted for Space.

OCCUPANCY CLASSIFICATION KEYS

OCCUPANCY USE KEY	OCCUPANCY GROUP KEY	OCCUPANCY GROUP	APPLICABLE CODE		
			2012	2015	2018
1.01 ASSEMBLY	A-1	Y	Y	Y	Y
1.02 ASSEMBLY	A-2	Y	Y	Y	Y
1.03 ASSEMBLY	A-3	Y	Y	Y	Y
1.04 ASSEMBLY	A-4	Y	Y	Y	Y
1.05 ASSEMBLY	A-5	Y	Y	Y	Y
2.00 BUSINESS	B	Y	Y	Y	Y
3.00 EDUCATIONAL	E	Y	Y	Y	Y
4.00 FACTORY	F-1	Y	Y	Y	Y
4.00 FACTORY	F-2	Y	Y	Y	Y
5.00 HIGH HAZARD	H-1	Y	Y	Y	Y
5.00 HIGH HAZARD	H-2	Y	Y	Y	Y
5.00 HIGH HAZARD	H-3	Y	Y	Y	Y
5.00 HIGH HAZARD	H-4	Y	Y	Y	Y
5.00 HIGH HAZARD	H-5	Y	Y	Y	Y
6.00 INSTITUTIONAL	I-1	Y	Y	Y	Y
6.00 INSTITUTIONAL	I-2	Y	Y	Y	Y
6.00 INSTITUTIONAL	I-3	Y	Y	Y	Y
6.00 INSTITUTIONAL	I-4	Y	Y	Y	Y
7.00 MISC. RESIDENTIAL	M	Y	Y	Y	Y
8.01 RESIDENTIAL	R-1	Y	Y	Y	Y
8.02 RESIDENTIAL	R-2	Y	Y	Y	Y
8.03 RESIDENTIAL	R-3	Y	Y	Y	Y
8.04 RESIDENTIAL	R-4	Y	Y	Y	Y
9.01 STORAGE	S-1	Y	Y	Y	Y
9.02 STORAGE	S-2	Y	Y	Y	Y
10.00 UTILITY AND MISCELLANEOUS	U	Y	Y	Y	Y

Tags

- What are Tags?
 - Annotation Families that returns data related to model elements.
- How do the Code Tools use tags?
 - Report Room/Area data in plan.
 - Report data related to the schedules.

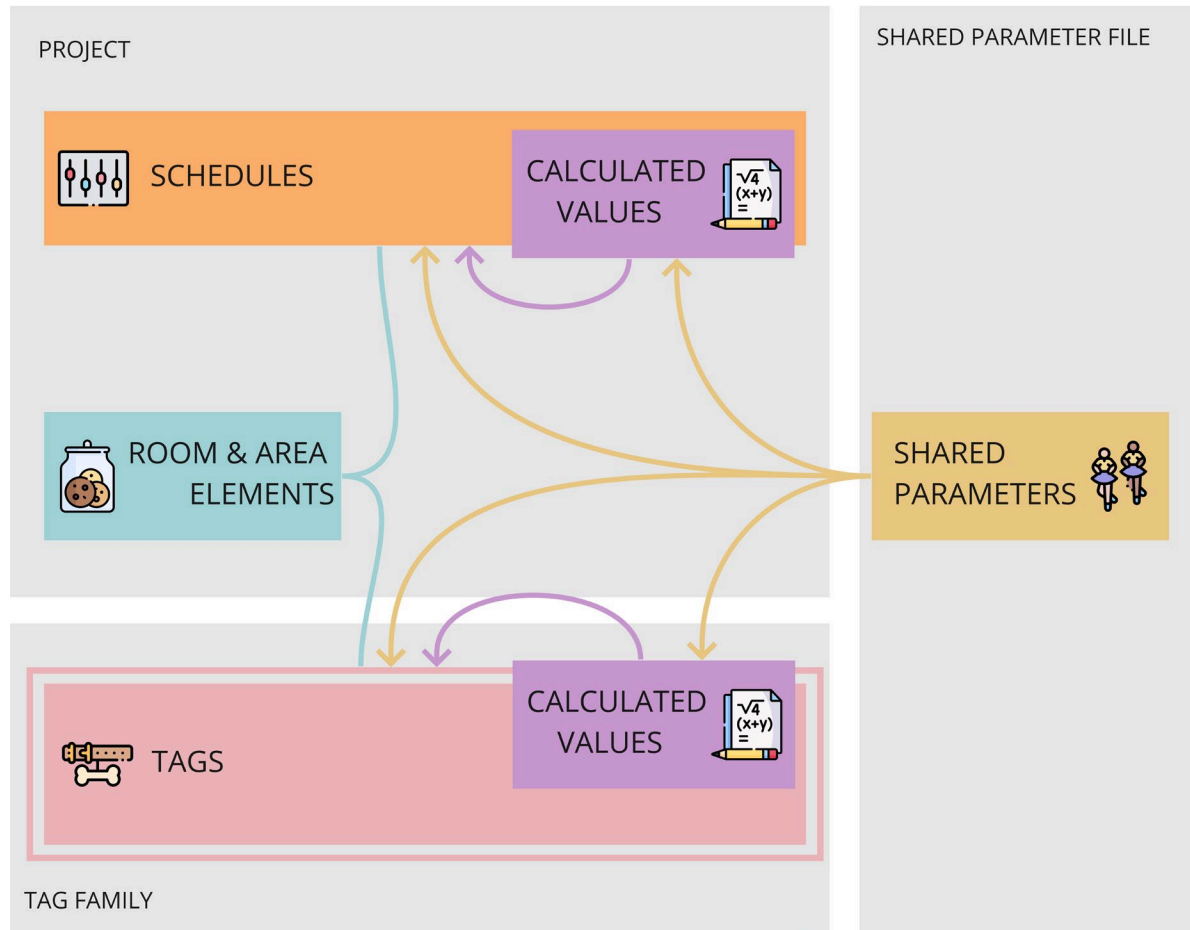

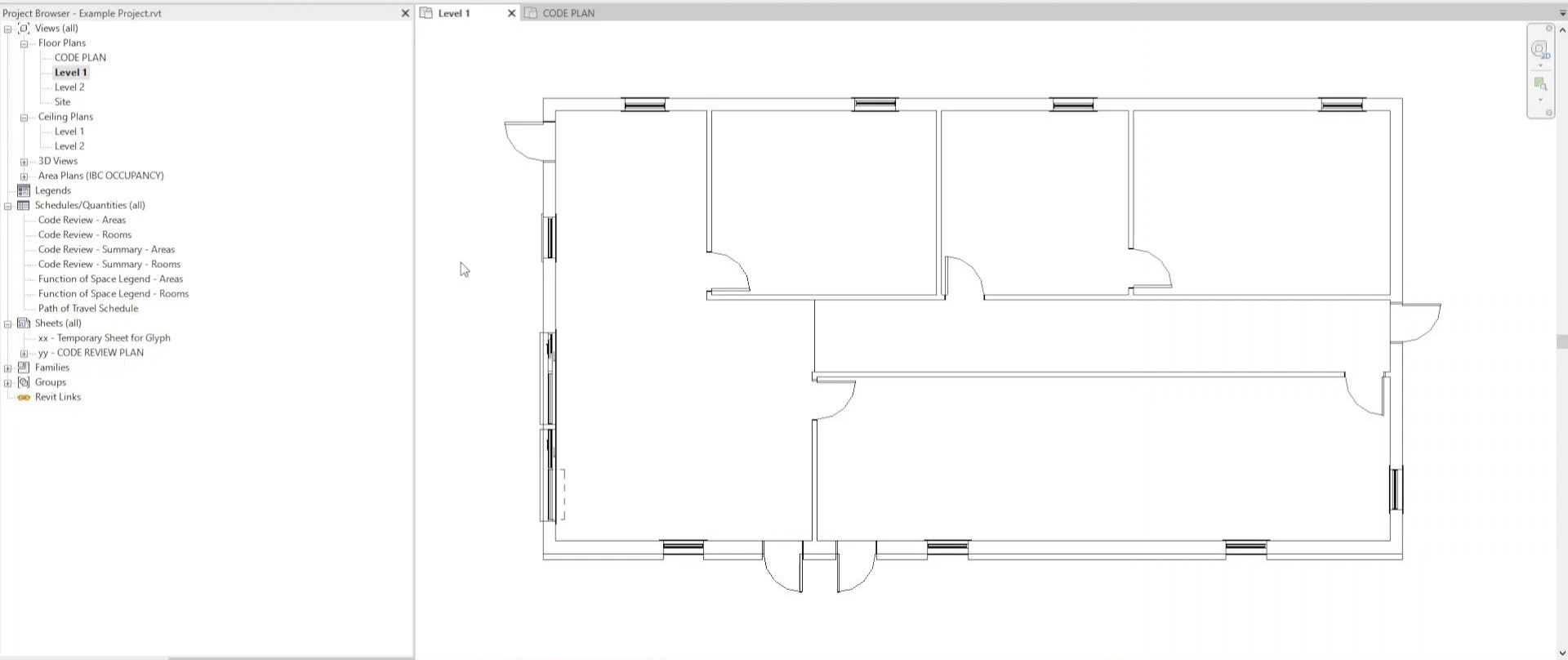
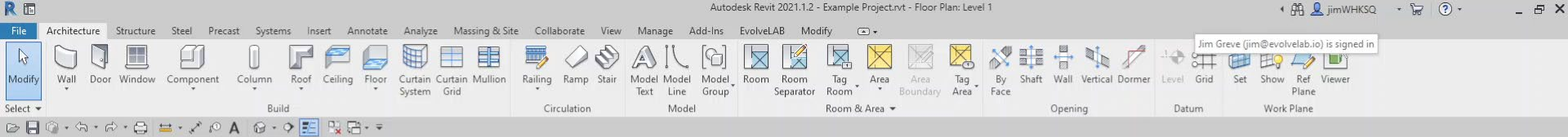

Shared Parameters

- What are Shared Parameters?
 - Custom parameters
 - Project Parameter
 - Family Parameter
 - Exterior File
- Why is it important?
 - Synchronization

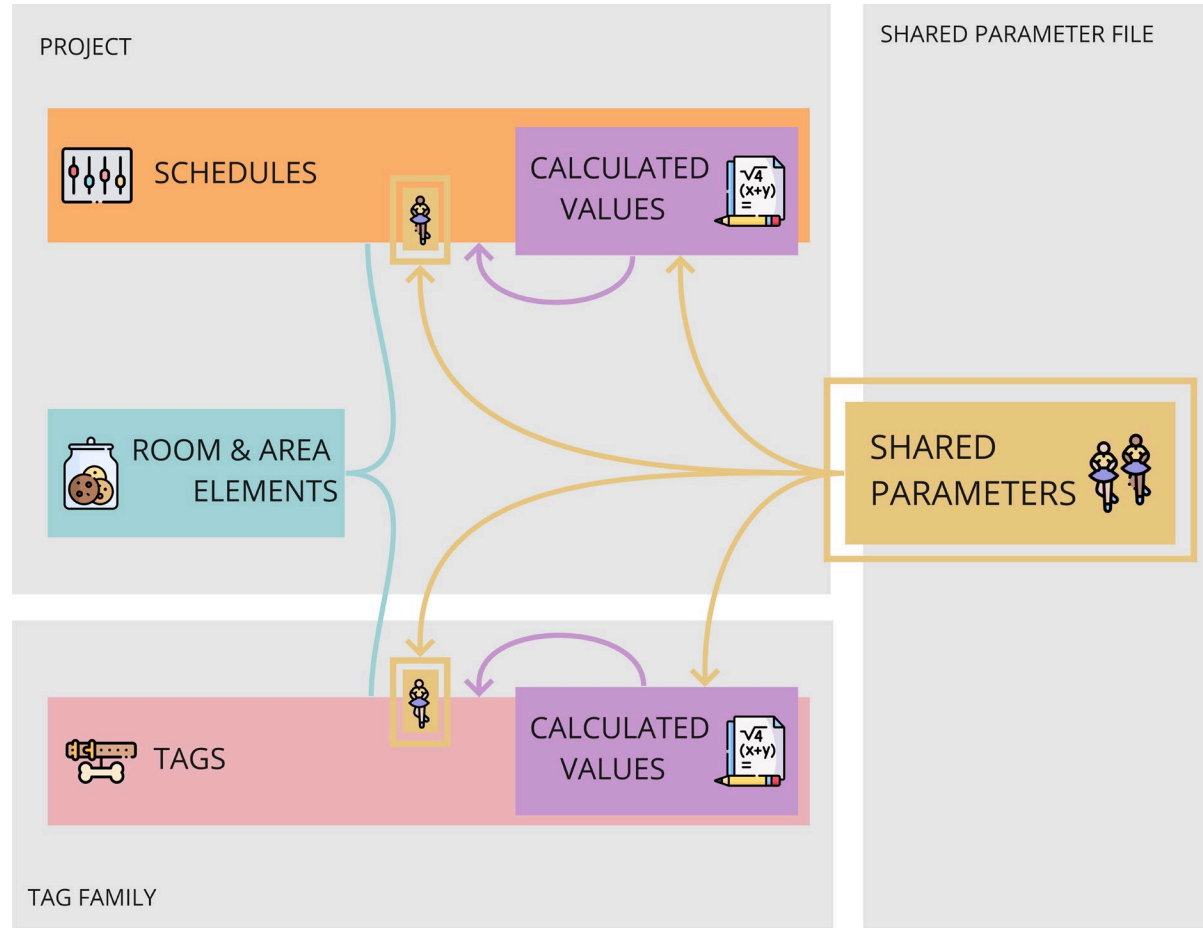

FileArchitectureStructureSteelPrecastSystemsInsertAnnotateAnalyzeMassing & SiteCollaborateViewManageAdd-InsEnscape™DiRootsEvolveLABLS3PpyRevitRhino.InsideModifyModify Schedule/Quantities

Category:0.0

Parameter:

Format Unit

Calculated

Combine Parameters

Insert Delete

Resize

Hide

Unhide All

Insert Data Row

Delete

Resize

Merge

Insert Image

Clear Cell

Group

Ungroup

Freeze Header

Shading

Borders

Reset

Font

Align Horizontal

Align Vertical

Highlight in Model

Show

Hide

Isolate

Explain

PropertiesParametersColumnsRowsTitles & HeadersAppearanceElementNot Placed/UnenclosedError

Modify Schedule/Quantities

Properties

Schedule

Schedule: Code Review - Rooms

Edit Type

Identity Data

Code Schedules

View Template

Code Review - Rooms

View Name

Code Review - Rooms

Dependency

Independent

EL_Filter_SP

Code Review - QA/QC

Phasing

Phase

New Construction

Other

Fields

Edit...

Filter

Edit...

Sorting/Grouping

Edit...

Formatting

Edit...

Appearance

Edit...

Embedded Schedule

Edit...

<Code Review - Rooms>

F	G	H	I	J	K	L	M	N	O	P	Q
Pancy Group	Function Of Space Key*	Function Of Space	Manual Occupancy Load Fact	Manual Net/Gross***	Occupancy Load Factor	Net/Gross	Area	Path of Travel**	Number of Occupants Add	Number Of Occup	Cumulative Number Of
2		Agricultural building	2		300	GROSS	870.83 SF		5	3	8
21		Mail buildings - covered and open	3	NET	-2	NET	870.83 SF		2	-435	-433
9		Business areas	200	NET/GROSS	100	GROSS	870.83 SF		1	9	10
9.01		Business areas - Concentrated business		NET/GROSS		NET/GROSS	870.83 SF				
9.01		Business areas - Concentrated business		NET/GROSS	-1	NET/GROSS	870.83 SF			-870	-870
9.01		Business areas - Concentrated business		NET/GROSS	-1	NET/GROSS	870.83 SF			-870	-870
22		Mercantile		NET/GROSS	60	GROSS	870.83 SF			15	15
22		Mercantile			60	GROSS	870.83 SF			15	15
22		Mercantile		NET/GROSS	-1	GROSS	870.83 SF			-870	-870
22.03		Mercantile - Basement and grade floor		-1	GROSS	870.83 SF				-870	-870
22.03		Mercantile - Basement and grade floor		-1	GROSS	870.83 SF				-870	-870
22.03		Mercantile - Basement and grade floor		30	GROSS	870.83 SF				30	30
7.01		Assembly without fixed seats - Concent		7	NET	870.83 SF				125	125
100		TBD		-1	TBD	870.83 SF			3	-870	-862
3333		TBD		NET/GROSS	-1	TBD	870.83 SF			-870	-870
21		Mail buildings - covered and open		NET/GROSS		NET/GROSS	870.83 SF				
21		Mail buildings - covered and open		GROSS		GROSS	870.83 SF				
21		Mail buildings - covered and open		NET		NET	870.83 SF				
21		Mail buildings - covered and open					870.83 SF				
21		Mail buildings - covered and open					870.83 SF				
12		Dormitories		50	GROSS	870.83 SF				18	
21		Mail buildings - covered and open	100	NET	100	NET	870.83 SF			9	9
13.02		Educational - Shops and other vocational		50	NET	870.83 SF				18	18
14		Exercise rooms		50	GROSS	870.83 SF				18	18
15		Group H-S fabrication and manufacturing		200	GROSS	870.83 SF				5	5
16		Industrial areas		100	GROSS	870.83 SF				9	9
17.01		Institutional areas - Inpatient treatment		240	GROSS	870.83 SF				4	4
						Not Placed					
17.02		Institutional areas - Outpatient areas		100	GROSS	723.48 SF			2	8	10
17.03		Institutional areas - Sleeping areas		120	GROSS	2003.81 SF			3	17	17
1		Accessory storage areas, mechanical e		300	GROSS	1412.52 SF			2	5	7
0		EGRESS*	70		0	*	152.38 SF		4		6

Properties help

Apply

Calculated Values

- What are Calculated Values?
 - Special type of parameters that processes data from other parameters
 - Formulas
 - Can be placed in:
 - Schedules
 - Families
 - Tag Family Labels

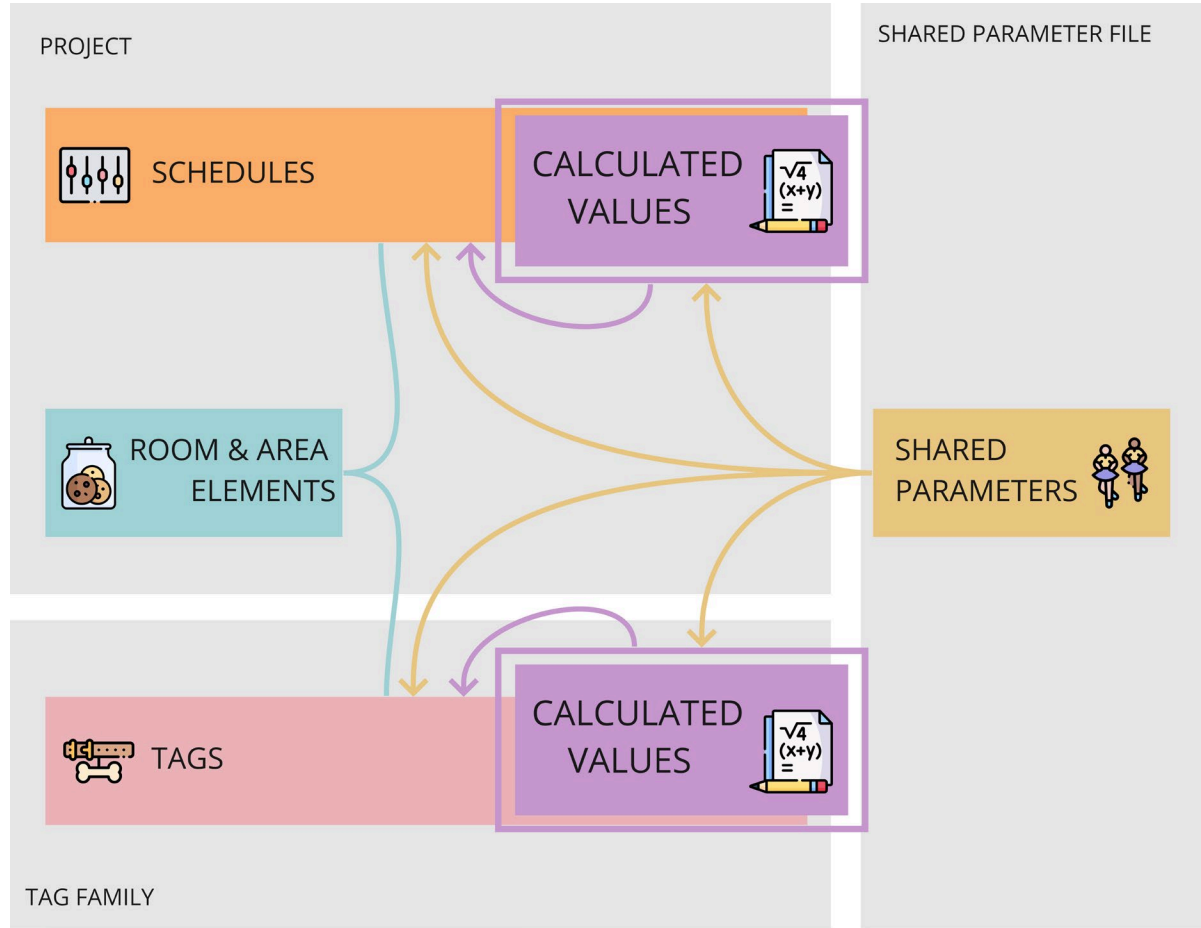

Code Review - Rooms

Name	Number	Code Year	Occupancy Use Key**	Occupancy Group Key	Occupancy Group	Function Of Space Key**	Function Of Space	Manual Occupancy Load Factor***	Manual Net/Gross***	Occupancy Load Factor	Net/Gross	Area	Path of Travel**	Number of Occupants Addition***	Number Of Occupants	Cumulative Number Of Occupants
Room 1	2018	1.0	TBD	TBD	2		Agricultural building	2		300	GROSS	870.83 SF	Yes	8	3	8
Room 2	2018	1.0	TBD	TBD	2		Mail buildings - covered and open	2	NET	-2	NET	870.83 SF	Yes	2	435	433
Room 3	2012	1.0	A-3	ASSEMBLY	9		Business areas - concentrated business use areas	200	NET/GROSS	100	GROSS	870.83 SF	Yes	1	9	10
Room 4	2018	1.0	A-4	ASSEMBLY	9		Business areas - concentrated business use areas		NET/GROSS		NET/GROSS	870.83 SF	No			
Room 5	2015	1.0	A-5	ASSEMBLY	9		Business areas - concentrated business use areas		NET/GROSS	-1	NET/GROSS	870.83 SF	No		-870	-870
Room 6	2012	2	B	BUSINESS	9		Business areas - concentrated business use areas		NET/GROSS	-1	NET/GROSS	870.83 SF			-870	
Room 7	2018	3	E	EDUCATIONAL	22		Mercantile		NET/GROSS	60	GROSS	870.83 SF	No		15	15
Room 8	2015	4.0	F-1	FACTORY	22		Mercantile		GROSS	60	GROSS	870.83 SF	No		15	15
Room 9	2012	4.0	F-2	FACTORY	22		Mercantile		NET/GROSS	-1	GROSS	870.83 SF			-870	
Room 10	2018	5.0	H-1	HIGH HAZARD	22		Mercantile - basement and grade floor areas		GROSS	-1	GROSS	870.83 SF			-870	
Room 11	2015	5.0	H-2	HIGH HAZARD	22		Mercantile - basement and grade floor areas		GROSS	-1	GROSS	870.83 SF	No		-870	-870
Room 12	2012	5.0	H-3	HIGH HAZARD	22		Mercantile - basement and grade floor areas		GROSS	30	GROSS	870.83 SF	No		30	30
Room 13	2018	5.0	H-4	HIGH HAZARD	7		Assembly without fixed seats - concentrated (chairs only—not fixed)		GROSS	7	NET	870.83 SF	No		125	125
Room 14	2018	5.0	H-5	HIGH HAZARD	100		TBD		GROSS	-1	TBD	870.83 SF	Yes	8	-870	-862
Room 15	2018	5.0	I-1	INSTITUTIONAL	21		TBD		NET/GROSS	-1	TBD	870.83 SF			-870	
Room 16	2012	5.0	I-2	INSTITUTIONAL	21		Mail buildings - covered and open		NET/GROSS		NET/GROSS	870.83 SF				
Room 17	2018	6.0	I-3	INSTITUTIONAL	21		Mail buildings - covered and open		GROSS		GROSS	870.83 SF				
Room 18	2015	6.0	I-4	INSTITUTIONAL	21		Mail buildings - covered and open		NET		NET	870.83 SF				
Room 19	2012	7	M	MERCANTILE	21		Mail buildings - covered and open		GROSS		GROSS	870.83 SF				
Room 20	2018	7	M	MERCANTILE	21		Mail buildings - covered and open		GROSS		GROSS	870.83 SF				
Room 21	2018	8.0	R-2	RESIDENTIAL	12		Dormitories		GROSS	50	GROSS	870.83 SF			18	
Room 22	2018	8.0	R-3	RESIDENTIAL	21		Mail buildings - covered and open	100	NET	100	NET	870.83 SF	No		9	9
Room 23	2018	8.0	R-4	RESIDENTIAL	13		Educational - shops and other vocational room areas		GROSS	50	NET	870.83 SF	No		18	18
Room 24	2018	9.0	S-1	STORAGE	14		Exercise rooms		GROSS	50	GROSS	870.83 SF	No		18	18
Room 25	2018	9.0	S-2	STORAGE	15		Group H-5 fabrication and manufacturing areas		GROSS	200	GROSS	870.83 SF	No		5	5
Room 26	2018	10	U	UTILITY AND	16		Industrial areas		GROSS	100	GROSS	870.83 SF	No		9	9
Room 27	2018	11	TBD	TBD	17		Institutional areas - inpatient treatment areas		GROSS	240	GROSS	870.83 SF	No		4	4
Room 28	2018	12	TBD	TBD	18		Institutional areas - outpatient areas		GROSS	240	GROSS	870.83 SF	No		4	4
LIVING	A1	2018	1.0	F-1	FACTORY	17		Institutional areas - outpatient areas		GROSS	723.48 SF	Yes	2	8	10	
COMMON	A2	2018	1.0	A-3	ASSEMBLY	17		Institutional areas - sleeping areas		GROSS	2003.81 SF	No	3	17	17	
CORRIDOR	A3	2018	2	B	BUSINESS	1		Accessory storage areas, mechanical equipment room		GROSS	1412.52 SF	Yes	2	5	7	
BEDROOM	A4	2018	1.0	A-2	ASSEMBLY	0		EGRESS*	70	0	*	152.38 SF	Yes	6		6



CALCULATED VALUES

Modify Schedule/Quantities

Schedule Properties

Fields | Filter | Sorting/Grouping | Formatting | Appearance | Embedded Schedule

Select available fields from: Rooms

Available fields:

- Base Finish
- Base Offset
- Ceiling Finish
- Comments
- Count
- Department
- EL_Filter_SP
- EL_Filter_SP
- Floor Finish
- IfcGUID
- Image
- Level
- Limit Offset
- Occupancy
- Perimeter
- Unbounded Height
- Upper Limit
- Volume
- Wall Finish

Scheduled fields (in order):

- Name
- Number
- EL_Code Year_SP
- EL_Occupancy Use Key_SP
- EL_Occupancy Group Key_CV
- EL_Occupancy Group_CV
- EL_Space Function Key_SP
- EL_Space Function_CV
- EL_Space Function - Req. Manual Input_CV
- EL_Occupancy Load Factor - Manual_SP
- EL_Net/Gross - Manual_SP
- EL_Occupancy Load Factor_CV
- EL_Net/Gross_CV
- Area
- EL_Path of Travel_SP
- EL_Number of Occupants Addition_SP
- EL_Number Of Occupants_CV
- EL_Number Of Occupants Cumulative_CV

Calculated Value

Name: EL_Number Of Occupants_CV

Formula: $\text{roundup}(\text{Area} / (\text{EL_Occupancy Load Factor_CV} * 1 * 1))$

Discipline: Common

Type: Integer

Fields

Select the field to be added to the formula

- Name
- Number
- EL_Code Year_SP
- EL_Occupancy Use Key_SP
- EL_Occupancy Group Key_CV
- EL_Occupancy Group_CV
- EL_Space Function Key_SP
- EL_Space Function_CV
- EL_Space Function - Req. Manual Input_CV
- EL_Occupancy Load Factor - Manual_SP
- EL_Net/Gross - Manual_SP
- EL_Occupancy Load Factor_CV
- EL_Net/Gross_CV
- Area
- EL_Path of Travel_SP

CALCULATED VALUES

**How do all the features
work together?**

SHARED PARAMETER FILE



PROJECT

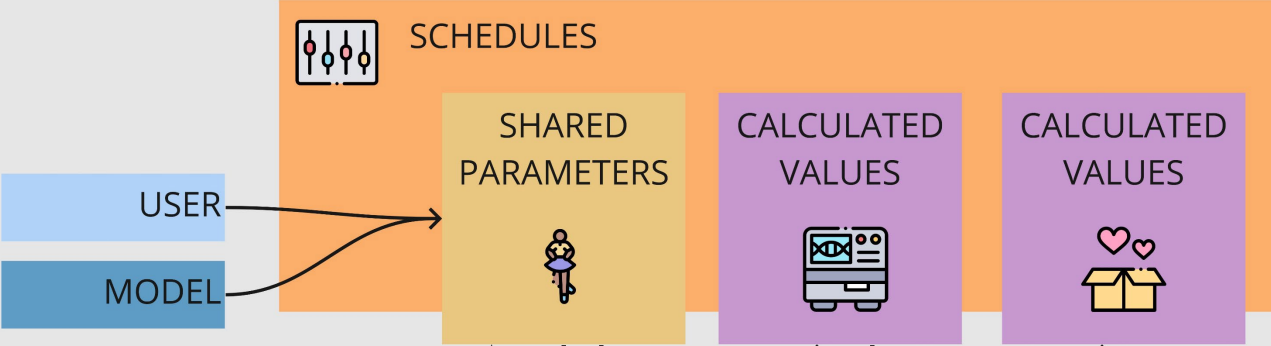

TAG FAMILY

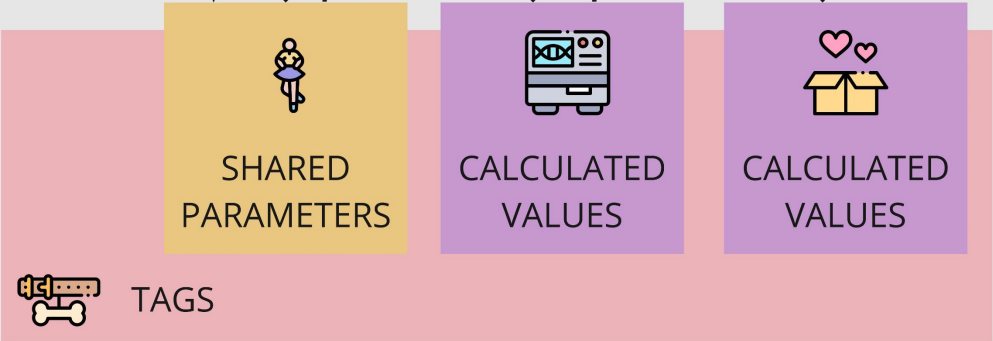

What is the Code Tools Calculation Process?



CODE YEAR

OCCUPANCY KEY

OCCUPANCY GROUP
KEY

OCCUPANCY GROUP

FUNCTION OF SPACE
KEY

FUNCTION OF SPACE

Per chapter 10, Maximum
Allowances per Occupant

MANUAL OCCUPANT
LOAD FACTOR

MANUAL NET
LOAD FACTOR

AREA

PATH OF TRAVEL

No OF OCCUPANTS
ADDITIONAL

OCCUPANCY CLASSIFICATION

OCCUPANCY USE KEY	OCCUPANCY GROUP KEY	
1.01	ASSEMBLY	A-1
1.02	ASSEMBLY	A-2
1.03	ASSEMBLY	A-3
1.04	ASSEMBLY	A-4
1.05	ASSEMBLY	A-5
2.00	BUSINESS	B
3.00	EDUCATIONAL	E
4.01	FACTORY	F-1
4.02	FACTORY	F-2
5.01	HIGH HAZARD	H-1
5.02	HIGH HAZARD	H-2
5.03	HIGH HAZARD	H-3
5.04	HIGH HAZARD	H-4
5.05	HIGH HAZARD	H-5
6.01	INSTITUTIONAL	I-1
6.02	INSTITUTIONAL	I-2
6.03	INSTITUTIONAL	I-3
6.04	INSTITUTIONAL	I-4
7.00	MERCANTILE	M
8.01	RESIDENTIAL	R-1
8.02	RESIDENTIAL	R-2
8.03	RESIDENTIAL	R-3
8.04	RESIDENTIAL	R-4
9.01	STORAGE	S-1
9.02	STORAGE	S-2
10.00	UTILITY AND MISCELLANEOUS	U

SPACE USAGE AND OCCUPANCY LOAD - PER CHAPTER 10

FUNCTION OF SPACE KEY	FUNCTION OF SPACE	OCC. LOAD FACTOR	NET/ GROSS	APPLICABLE CODE			
				2012	2015	2018	
1.00	Accessory storage areas, mechanical equipment room	300 GROSS		Y	Y	Y	
2.00	Agricultural building	300 GROSS		Y	Y	Y	
3.00	Aircraft hangars	500 GROSS		Y	Y	Y	
	Airport terminal						
4.01	Airport terminal - Baggage claim	20 GROSS		Y	Y	Y	
4.02	Airport terminal - Baggage handling	300 GROSS		Y	Y	Y	
4.03	Concourse, Airport terminal	100 GROSS		Y	Y	Y	
4.04	Airport terminal - Waiting areas	15 GROSS		Y	Y	Y	
	Assembly						
5.01	Assembly - Gaming floors (keno, slots, etc.)	11 GROSS		Y	Y	Y	
5.02	Assembly - Exhibit gallery and museum	20 NET		Y	Y	Y	
6.00	Assembly with fixed seats		SEE CODE	Y	Y	Y	
	Assembly without fixed seats			Y	Y	Y	
	Assembly without fixed seats - Concentrated (chairs only—not fixed)	7 NET		Y	Y	Y	
7.02	Assembly without fixed seats - Standing space	5 NET		Y	Y	Y	
	Assembly without fixed seats - Unconcentrated (tables and chairs)						
7.03		15 NET		Y	Y	Y	
	Bowling centers, allow 5 persons for each lane including 15 feet of runway, and for additional areas	7 NET		Y	Y	Y	
8.00		150 GROSS		Y	Y	Y	
9.00	Business areas	100 GROSS		Y	Y	Y	
	Business areas - Concentrated business use areas		SEE CODE	Y	Y	Y	
10.00	Courtrooms—other than fixed seating areas	40 NET		Y	Y	Y	
11.00	Day care	35 NET		Y	Y	Y	
12.00	Dormitories	50 GROSS		Y	Y	Y	
	Educational						
13.01	Educational - Classroom area	20 NET		Y	Y	Y	
13.02	Educational - Shops and other vocational room areas	50 NET		Y	Y	Y	
14.00	Exercise rooms	50 GROSS		Y	Y	Y	
15.00	Group H-5 fabrication and manufacturing areas	200 GROSS		Y	Y	Y	
16.00	Industrial areas	100 GROSS		Y	Y	Y	
	Institutional areas						
17.01	Institutional areas - Inpatient treatment areas	240 GROSS		Y	Y	Y	
17.02	Institutional areas - Outpatient areas	100 GROSS		Y	Y	Y	
17.03	Institutional areas - Sleeping areas	120 GROSS		Y	Y	Y	
18.00	Kitchens, commercial	200 GROSS		Y	Y	Y	
	Library						
19.01	Library - Reading rooms	50 NET		Y	Y	Y	
19.02	Library - Stack area	100 GROSS		Y	Y	Y	
20.00	Locker rooms	20 GROSS		Y	Y	Y	
21.00	Mall buildings—covered and open		SEE CODE	Y	Y	Y	
	Mercantile						
22.00		50 GROSS		Y	Y	Y	
22.01	Mercantile - Storage, stock, shipping areas	300 GROSS		Y	Y	Y	
22.02	Mercantile - Areas on other floors	60 GROSS		Y	Y	Y	
22.03	Mercantile - Basement and grade floor areas	30 GROSS		Y	Y	Y	
23.00	Parking garages	200 GROSS		Y	Y	Y	
24.00	Residential	200 GROSS		Y	Y	Y	
	Recreation						
25.01	Skating rinks, swimming pools	50 GROSS		Y	Y	Y	
25.02	Skating rinks, swimming pools - Rink and pool	15 GROSS		Y	Y	Y	
26.00	Stages and platforms	15 NET		Y	Y	Y	
27.00	Warehouses	500 GROSS		Y	Y	Y	
0.00	EGRESS*	0					

* - Egress value is not defined by the Maximum Floor Area Allowances Per Occupant table in Chapter 10, but an addition to help integrate those spaces in the Code Tools. These Spaces skip the standard process of defining the Number of Occupants by the Occupant Load Factor and instead has only a Cumulative Number Of Occupants based solely in the Number of Occupants Addition.

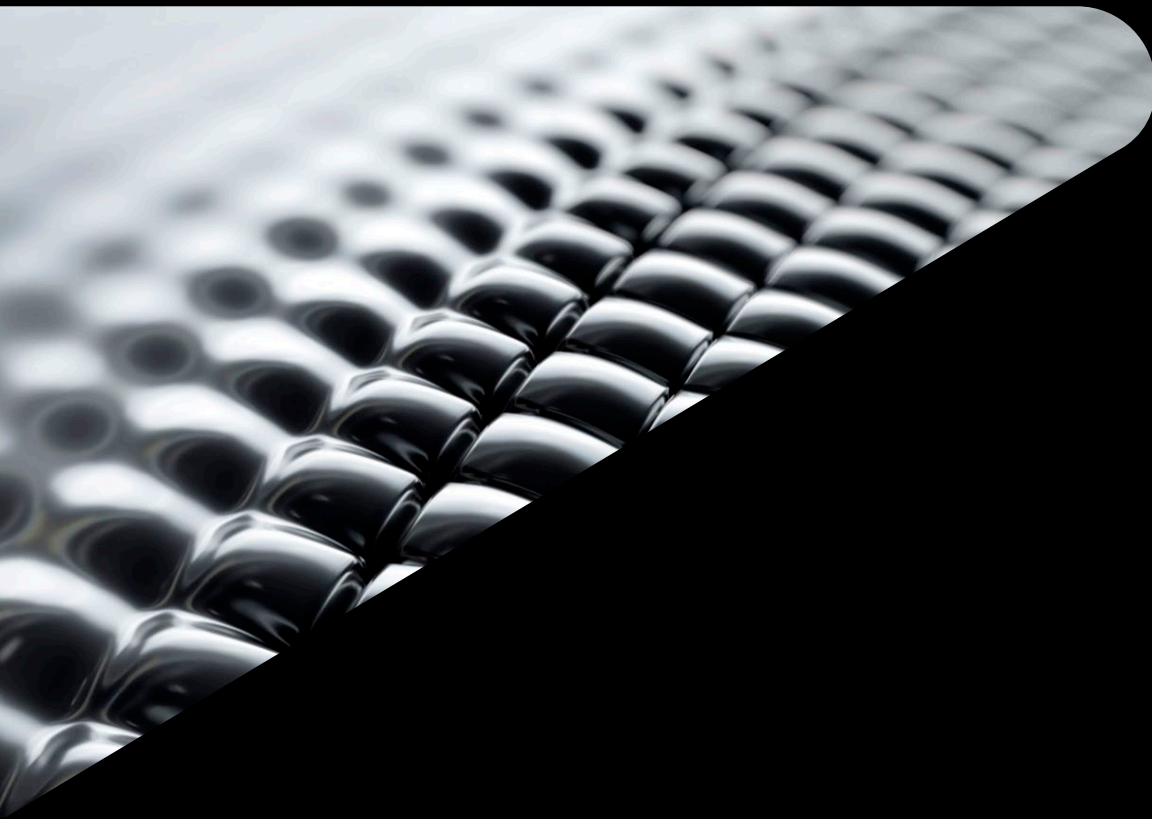

Extra Tools

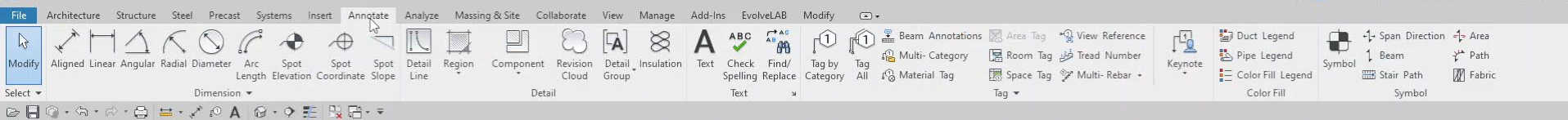

Properties

Code Review - Summary - Rooms Code Review - Rooms 00 - Code Review **CODE PLAN** X

Floor Plan

Floor Plan: CODE PLAN Edit Type

Graphics

View Scale: 1/4" = 1'-0"

Scale Value: 1: 48

Display Model: Normal

Detail Level: Coarse

Parts Visibility: Show Original

Visibility/Graphics...: Edit...

Graphic Display O...: Edit...

Orientation: Project North

Wall Join Display: Clean all wall joins

Discipline: Architectural

Show Hidden Lines: By Discipline

Color Scheme Loc...: Background

Color Scheme: <none>

System Color Sch...: Edit...

Default Analysis D...: None

Sun Path: ☐

Underlay

Range: Base Level: None

Range: Top Level: Unbounded

Underlay Orientati...: Look down

Extents

Crop View: ☐

Crop Region Visible: ☐

Annotation Crop: ☐

View Range: Edit...

Associated Level: Level 1

Scope Box: None

Depth Clipping: No clip

Identity Data

View Template: <None>

View Name: CODE PLAN

Dependency: Independent

Title on Sheet

Referencing Sheet

Referencing Detail

[Properties help](#) Apply

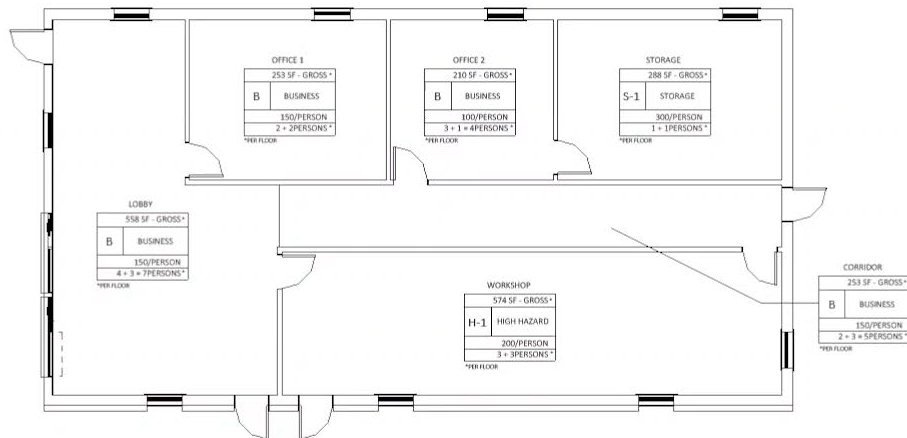

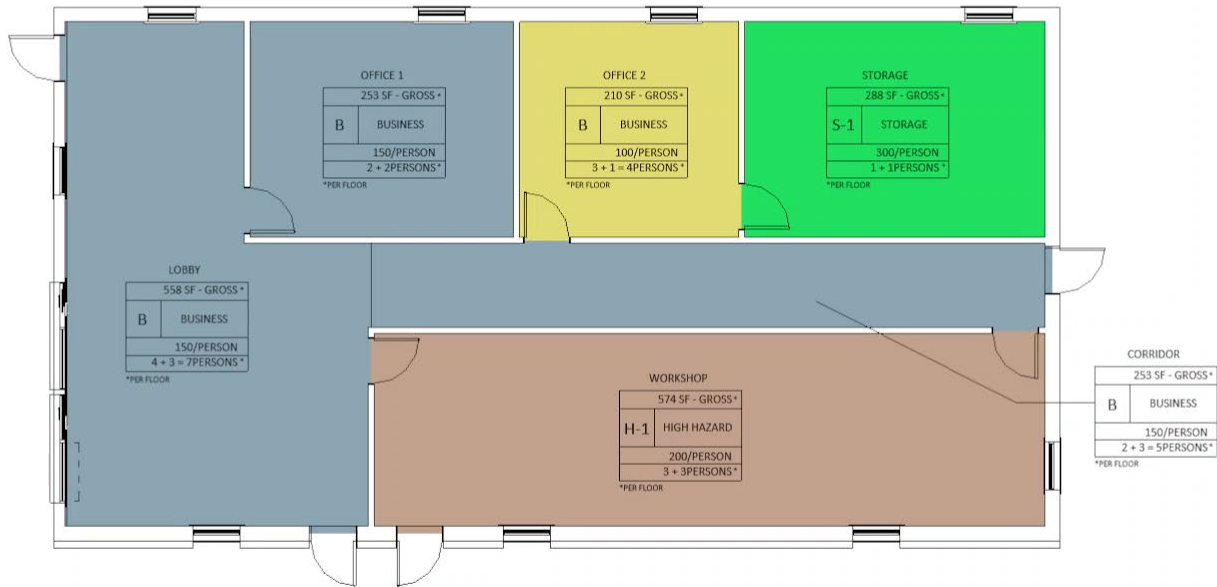
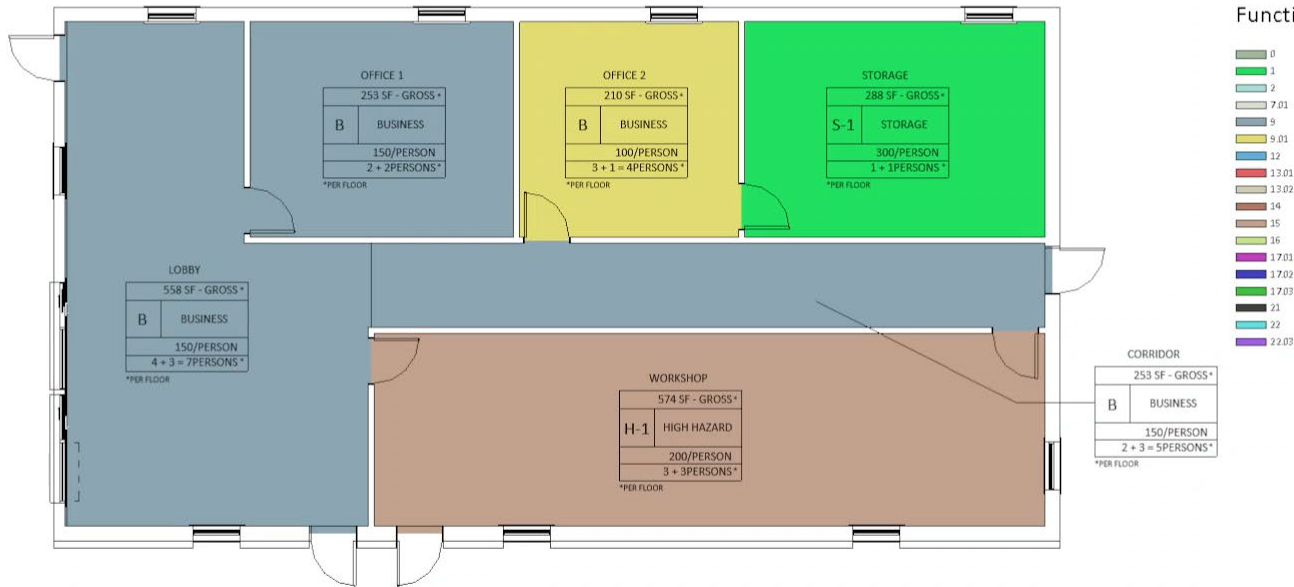

Autodesk Revit 2021.1.2 - Project1.rvt - Floor Plan: CODE PLAN

File Architecture Structure Steel Precast Systems Insert Annotate Analyze Massing & Site Collaborate View Manage Add-Ins EvolveLAB Modify | <Path of Travel Lines>

Modify | <Path of Travel Lines>

Properties

yy - CODE REVIEW PLAN CODE PLAN

<Path of Travel Lines> (1) Edit Type

Graphics

Line Style	EL_Path of Travel - (
Detail Line	<input checked="" type="checkbox"/>

Dimensions

Length	47' 0.241/256"
Time	10.700 s
Speed	3.000 mph

Identity Data

Mark	MAXIMUM:
Level	Level 1
View Name	CODE PLAN
From Room	OFFICE 1 102
To Room	

Properties help Apply

MAXIMUM: 47' - 1"

OFFICE 1

253 SF - GROSS*	
B	BUSINESS
150/PERSON	
2 + 2PERSONS*	
*PER FLOOR	

OFFICE 2

210 SF - GROSS*	
B	BUSINESS
100/PERSON	
3 + 1 = 4PERSONS*	
*PER FLOOR	

LOBBY

558 SF - GROSS*	
B	BUSINESS
150/PERSON	
4 + 3 = 7PERSONS*	
*PER FLOOR	

WORKSHOP

574 SF - GROSS*	
-----------------	--

FIRE RATING FILTER OVERRIDES

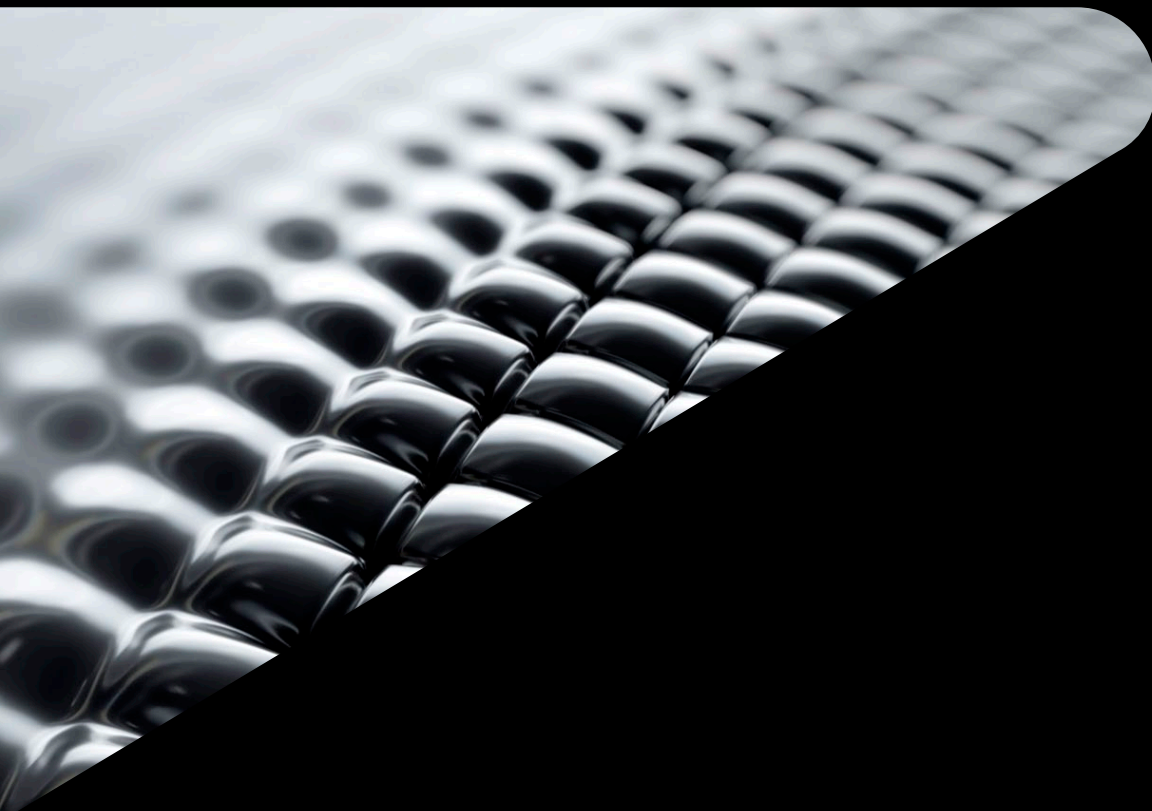

**What have
we learned?**

How do the Code Tools use Revit?

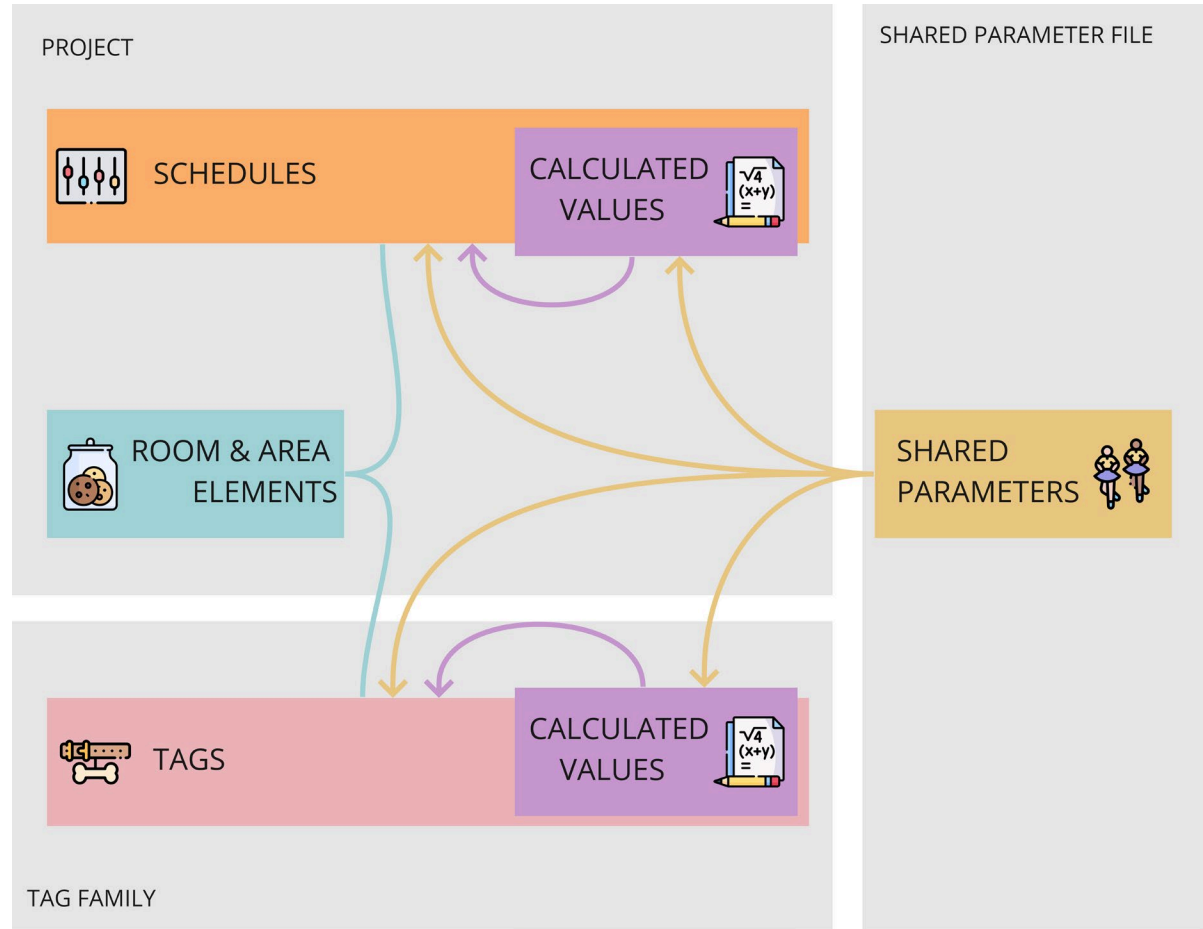

FileArchitectureStructureSteelPrecastSystemsInsertAnnotateAnalyzeMassing & SiteCollaborateViewManageAdd-InsEvolvelABModifyModify Schedule/Quantities

PropertiesName0.0FormatUnitCalculatedCombineParametersInsertDeleteResizeHideUnhideAllInsertInsert Data RowDeleteResizeMergeInsert ImageClear CellGroup UngroupFreeze HeaderShadingBordersResetFontAlign HorizontalAlign VerticalHighlight in ModelShowHideIsolateExplain

PropertiesParametersColumnsRowsTitles & HeadersAppearanceElementNot Placed/UnenclosedError

Modify Schedule/Quantities

PropertiesCode Review - Rooms X

Schedule

Schedule: Code Review - Roo Edit Type

Identity DataView TemplateCode SchedulesView NameCode Review - RoomsDependencyIndependentEl_Filter_SPCode Review - QA/QCPhasingPhaseNew ConstructionOtherFieldsEdit...FilterEdit...Sorting/GroupingEdit...FormattingEdit...AppearanceEdit...Embedded ScheduleEdit...

Name	Number	Code Year*	Occupancy Use Key	Occupancy Group Key	Occupancy Group	Function Of Space Key*	Function Of Space	Manual Occupa
LOBBY	101							
OFFICE 1	102							
OFFICE 2	103							
STORAGE	104							
CORRIDOR	105							
WORKSHOP	106							

Level 1

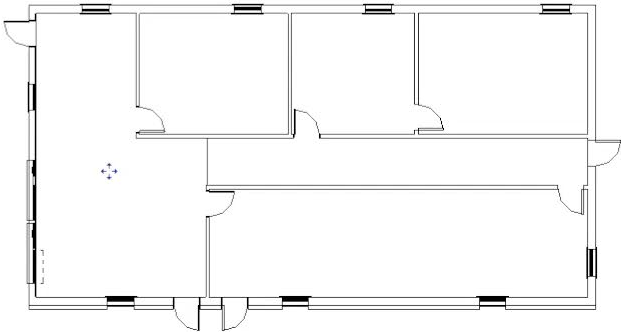

00 - Code Review

KEY TO BUILD SPACE (NOT TO BE USED): TO HELP GROUP SIMILARITIES, IT SET BUILDING KEY TO VERTICAL, AND BUILDING A LATER WITH THE SHORTEST NAME FIRST. Occupancy Group and Occupancy Group Key will be assigned as "TBD". A value for this parameter must always be inputted for Space.

OCCUPANCY USE KEY	OCCUPANCY GROUP KEY	OCCUPANCY GROUP	APPLICABLE CODE		
			2012	2015	2018
1.01 ASSEMBLY	A-1	Y	Y	Y	Y
1.02 ASSEMBLY	A-2	Y	Y	Y	Y
1.03 ASSEMBLY	A-3	Y	Y	Y	Y
1.04 ASSEMBLY	A-4	Y	Y	Y	Y
1.05 ASSEMBLY	A-5	Y	Y	Y	Y
2.00 BUSINESS	B	Y	Y	Y	Y
3.00 EDUCATIONAL	E	Y	Y	Y	Y
4.00 FACTORY	F-1	Y	Y	Y	Y
4.00 FACTORY	F-2	Y	Y	Y	Y
5.00 HIGH HAZARD	H-1	Y	Y	Y	Y
5.00 HIGH HAZARD	H-2	Y	Y	Y	Y
5.00 HIGH HAZARD	H-3	Y	Y	Y	Y
5.00 HIGH HAZARD	H-4	Y	Y	Y	Y
5.00 HIGH HAZARD	H-5	Y	Y	Y	Y
6.00 INSTITUTIONAL	I-1	Y	Y	Y	Y
6.00 INSTITUTIONAL	I-2	Y	Y	Y	Y
6.00 INSTITUTIONAL	I-3	Y	Y	Y	Y
6.00 INSTITUTIONAL	I-4	Y	Y	Y	Y
7.00 MERCANTILE	M	Y	Y	Y	Y
8.01 RESIDENTIAL	R-1	Y	Y	Y	Y
8.02 RESIDENTIAL	R-2	Y	Y	Y	Y
8.03 RESIDENTIAL	R-3	Y	Y	Y	Y
8.04 RESIDENTIAL	R-4	Y	Y	Y	Y
9.01 STORAGE	S-1	Y	Y	Y	Y
9.02 STORAGE	S-2	Y	Y	Y	Y
10.00 UTILITY AND MISCELLANEOUS	U	Y	Y	Y	Y

EVOLVELAB CODE TOOLS - SUMMARY



Copyright Mentions

- Icons

- Freepik – Flaticon

- `Cookie icons created by Freepik - Flaticon`
 - `Adjust icons created by Freepik - Flaticon`
 - `Slider icons created by Freepik - Flaticon`
 - `Math icons created by Freepik - Flaticon`
 - `Lab icons created by Freepik - Flaticon`
 - `Love icons created by Freepik - Flaticon`
 - `Choreography icons created by Freepik - Flaticon`

